

NEW LEADER



MODEL L2000G4 Parts List

UNIT SERIAL NO. _____

MANUAL NUMBER: 307467-AB-E

EFFECTIVE 06/2016



Highway Equipment Company

Building the best since 1939.

1330 76TH AVE SW
CEDAR RAPIDS, IA 52404-7052
PHONE (319) 363-8281 | FAX (319) 286-3350
www.highwayequipment.com

Copyright 2003 Highway Equipment Company, Inc.

Table of Contents	2
Interactive Features	3
Instructions for Ordering Parts	4
Body	5
Mounting Angle	5
Inverted "V"	6
Bin Sensor	7
Sight Window	8
Fenders	9
Truck Tires 96"	9
Semi-Float Tires 108"	10
Super Flotation Tires 132"	12
Hydraulics	13
Pump Hydraulics	13
Body Hydraulics	14
Spinner Hydraulics	16
Hydraulic Reservoir	19
Conveyor	20
#4 Belt-Over-Chain (BOC) Conveyor	20
Chain Shields	21
#4 Conveyor Idler	22
#4 Conveyor Drive	23
Conveyor Chain Oiler	24
#5 Belt Conveyor	28
#5 Belt Shields	29
#5 Conveyor Idler	30
#5 Conveyor Drive	31
Gearcase Assembly	32
Gearcase Service Parts	33
Encoder	34
Front Wiper	35
Feedgate	36
Endgate, Feedgate & Jack	36
Spinners	38
Material Divider	38
Hillside Divider	39
Spinner Assembly	40
SPinner Speed Sensor	42
Decals	43

NOTE:

This manual incorporates several interactive features to provide supplemental information and ease of navigation. The information below is to aid in the identification and use of these features.

Hyperlinks

Hyperlinks provide direct access to a specific destination when clicked. The entire Table of Contents of this manual is hyperlinked to provide quick access to all sections of this manual when viewing the electronic version.

Hyperlinks within the content are denoted by **[blue, bold underlined text](#)**. Electronic format viewers can click these links for direct access to New Leader online features. Internet access is required.

Quick Reference (QR) Codes

Quick reference codes provide direct access to a specific destination when activated. An example is provided below. In the printed version of this manual, viewers may scan the codes with a supporting mobile device for direct access to New Leader online features. Mobile data is required.

The electronic version of this manual provides the option to scan codes on-screen, or to click the code like a button. Internet access/mobile data is required.



Click or Scan - Highwayequipment.com



Order from the **AUTHORIZED DEALER** in your area.

1. Always give the pertinent model and serial number.
2. Give part name, part number and the quantity required.
3. Give the correct address to where the parts are to be shipped, and the carrier if there is a preference.

Unless claims for shortages or errors are made immediately upon receipt of goods they will not be considered. Any part returns should be directed through the dealer from which they were purchased.

When broken goods are received, a full description of the damage should be made by the carrier agent on the freight bill. If this description is insisted upon, full damage can always be collected from the transportation company.

No responsibility is assumed for delay or damage to merchandise while in transit. Our responsibility ceases upon delivery of shipment to the transportation company from whom a receipt is received showing that shipment was in good condition when delivered to them, therefore, claims (if any) should be filed with the transportation company and not with Highway Equipment Company.

If your claims are not being handled (by the transportation company) to your satisfaction, please call our Product Sales & Support Department at Highway Equipment Company at 888-363-8006 for assistance.

In the parts list the following symbols and abbreviations stand for:

- * - Not Shown
- AR – As Required
- CS – Carbon Steel
- SS – Stainless Steel
- NS – Not Serviced

The parts listed under the different steel types (CS, 409 SS and 304 SS) are for that type of unit and do not necessarily mean the part is made of that type of steel.

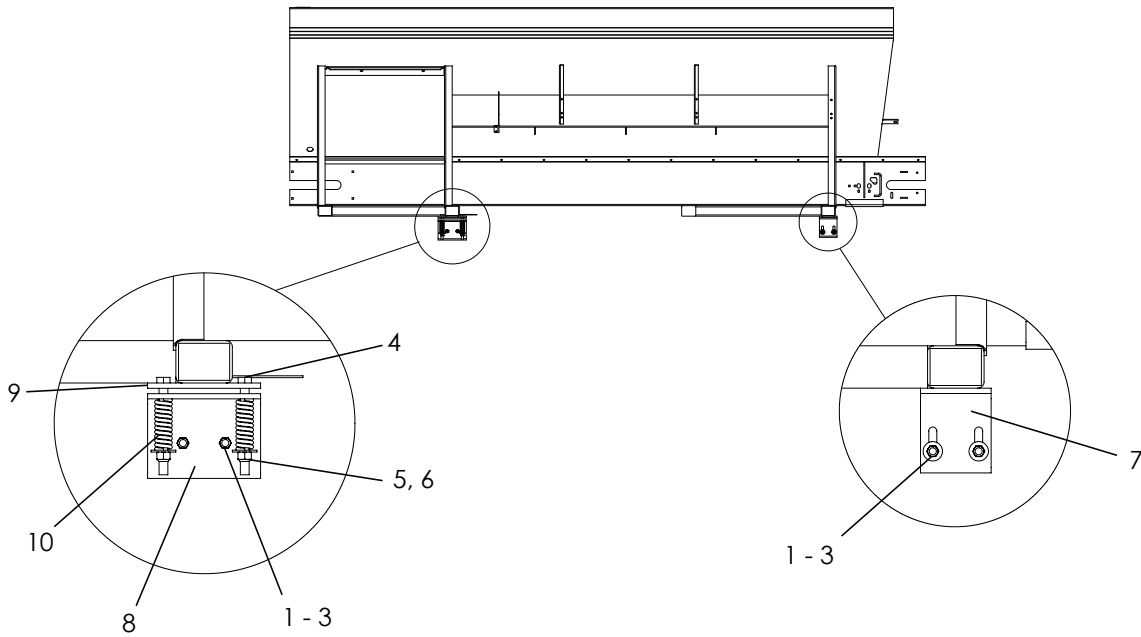

<u>ITEM</u>	<u>PART NO.</u>	<u>DESCRIPTION</u>	<u>QTY</u>
	305579-AB	Hardware Kit - Includes 1 - 6	
1	20131	Cap Screw - 1/2-13NC x 2	12
2	20695	Washer – Flat 1/2	12
3	20680	Nut - Lock 1/2-13NC	12
4	41762	Nut – Lock 5/8-11NC	4
5	20195	Cap Screw - 5/8-11NC x 6-1/2	4
6	20697	Washer – Flat 5/8	4
7	31856	Angle - Mounting	2
8	81847	Angle - Tie Down	2
9	81848	Mounting - Bar	2
10	81000	Spring	4

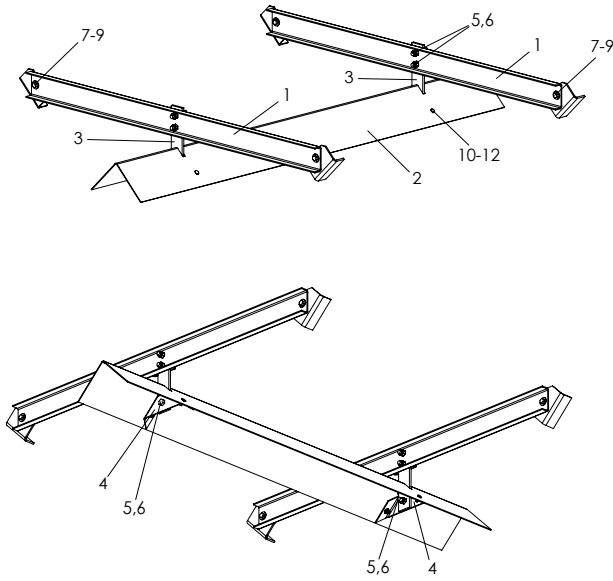

STANDARD (LOWER) ASSY

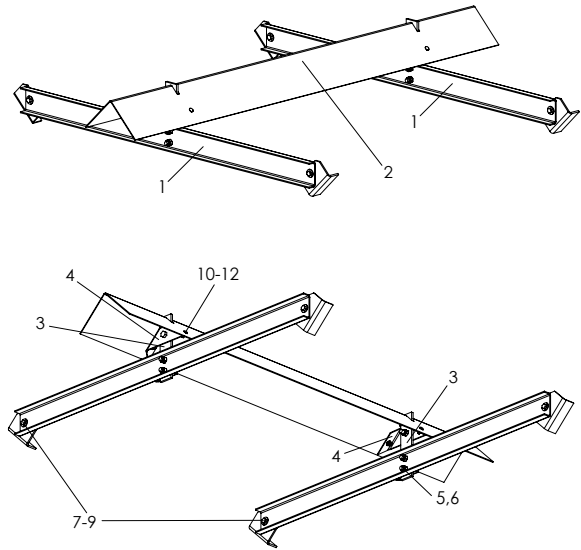

HIGH YIELD ASSY



Click image to play assembly video.

ITEM	PART NO.	DESCRIPTION	QTY
	409 SS 304 SS		
1	81262 81263	Hanger – V Wldmt	3
2	82618 82622	Inverted V - 7' (11' - 12' Units)	1
	82619 82623	Inverted V – 9' (13' - 14' Units)	1
	82620 82624	Inverted V - 11' (15' - 16' Units)	1
3	308646 308646	Bar – Adjusting	3
4	302371 302371	Bracket – V Bolt-on	3
5	58800 58800	Cap Screw – 5/8-11NC x 1-3/4 SS	9
6	41762 41762	Nut - Lock 5/8-11NC SS	9
7	36402 36402	Cap Screw - 1/2-13NC x 1-1/4 SS	6
8	36426 36426	Washer - Flat 1/2 SS	6
9	39016 39016	Nut - Lock 1/2-13NC SS	6
10	42639 42639	Bolt - Carriage 5/16-18NC x 1 SS	6
11	36424 36424	Washer - Flat 5/16 SS	6
12	42221 42221	Nut - Lock 5/16-18NC SS	6

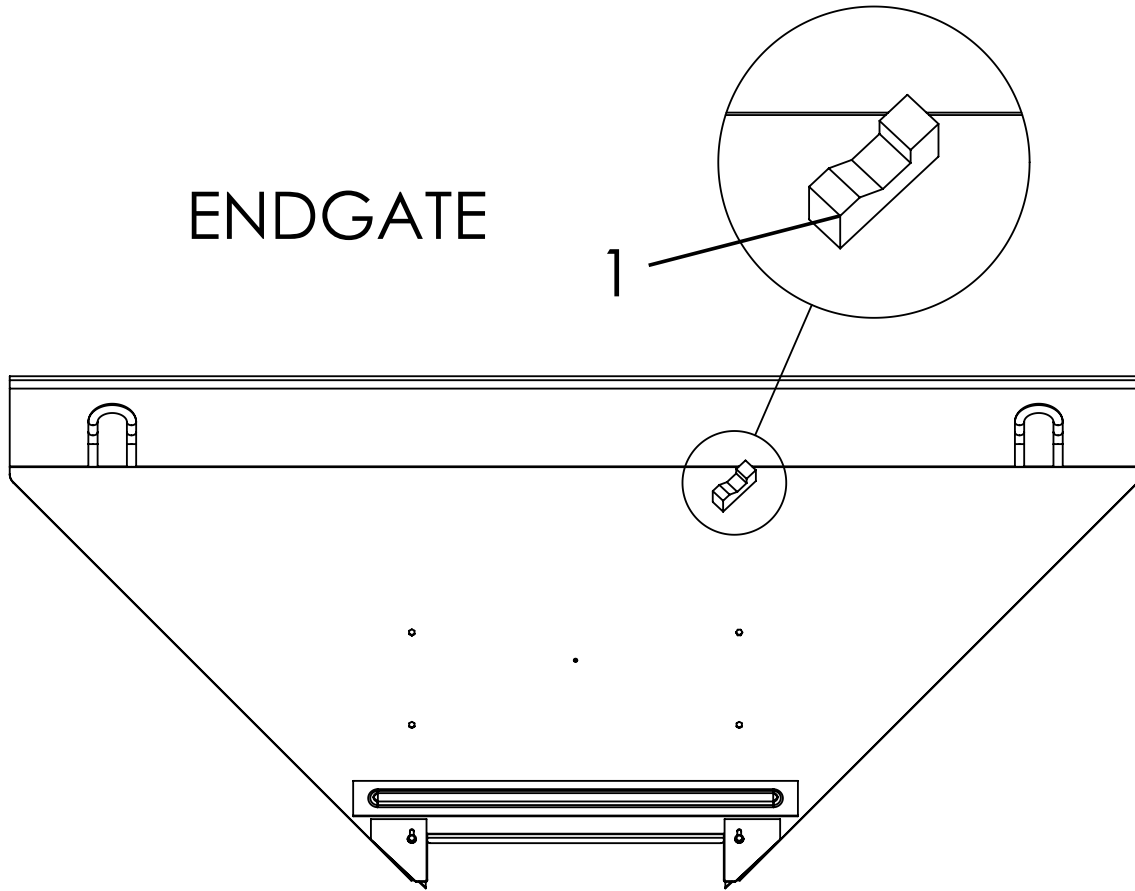

Click or Scan - Bin Sensor Test Procedure

<u>ITEM</u>	<u>PART NO.</u>	<u>DESCRIPTION</u>	<u>QTY</u>
1	98787-AB	Sensor - Bin Level w/ 18" Lead	AR

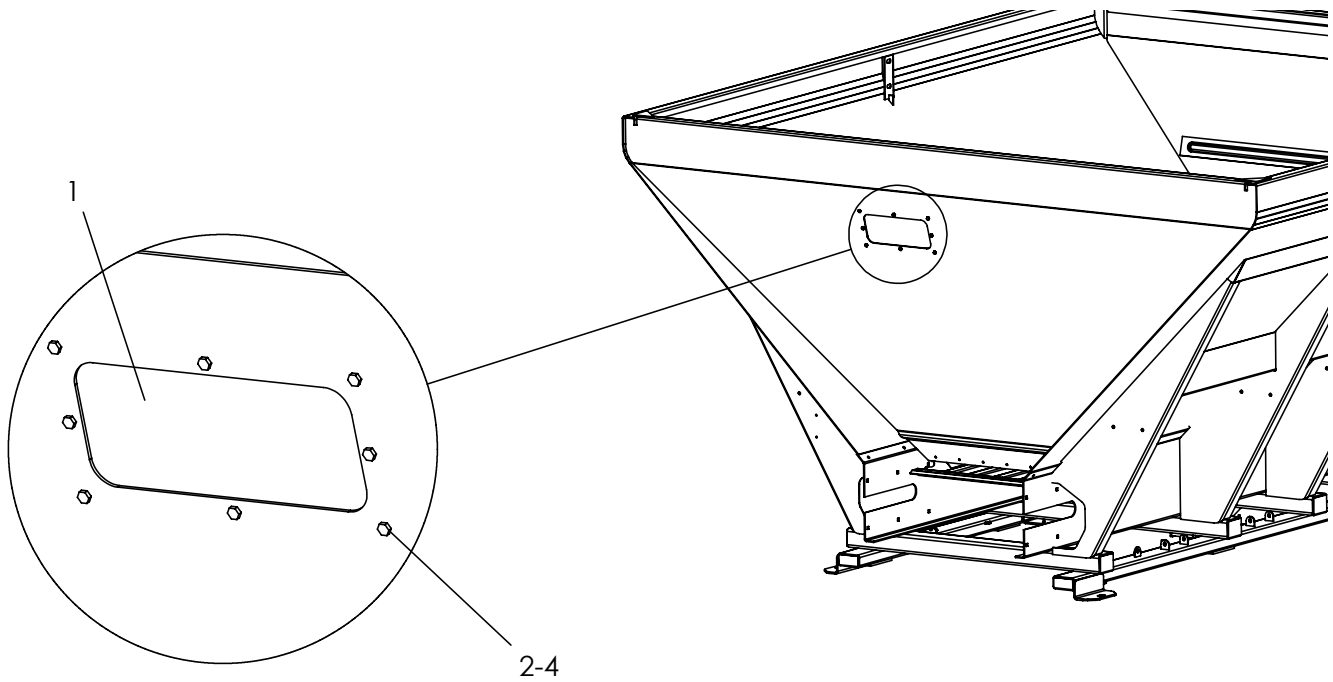

<u>ITEM</u>	<u>PART NO.</u>	<u>DESCRIPTION</u>	<u>QTY</u>
1	302686	Window - Sight 5" x 12"	1
2	36395	Cap Screw - 1/4-20NC x 1 SS	8
3	36423	Washer - Flat 1/4 SS	8
4	42034	Nut - Lock 1/4-20NC SS	8

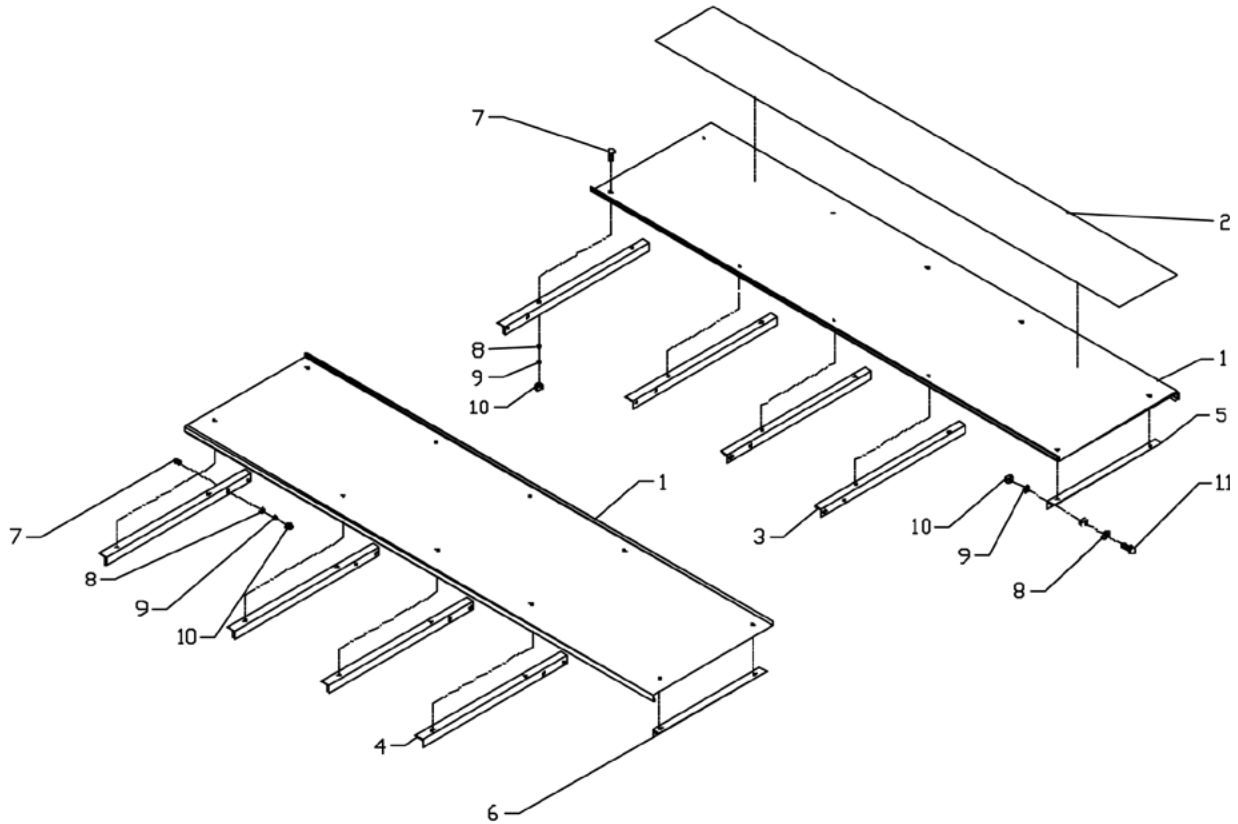

<u>ITEM</u>	<u>PART NO.</u>		<u>DESCRIPTION</u>	<u>QTY</u>
	<u>409</u>	<u>304</u>		
1	313076	--	Fender - 9' Unit	2
	81441	81464	Fender - 10' Unit	2
	81442	81465	Fender - 11' Unit	2
	81443	81466	Fender - 12' Unit	2
	81444	81467	Fender - 13' Unit	2
2	21699	21699	Material - Non-Skid, 8" Wide	Inches AR
3	98070	98070	Angle - Fender	AR
4	98071	98071	Angle - Fender	AR
5	71900	71872	Bracket - Mudflap RH	1
6	71901	71873	Bracket - Mudflap LH	1
7	36408	36408	Bolt - Carriage 3/8 x 1	AR
8	36425	36425	Washer - Flat 3/8	AR
9	36420	36420	Washer - Lock 3/8	AR
10	36414	36414	Nut - Hex 3/8	AR
11	36398	36398	Bolt - Carriage 3/8 x 1	4

AR - As Required

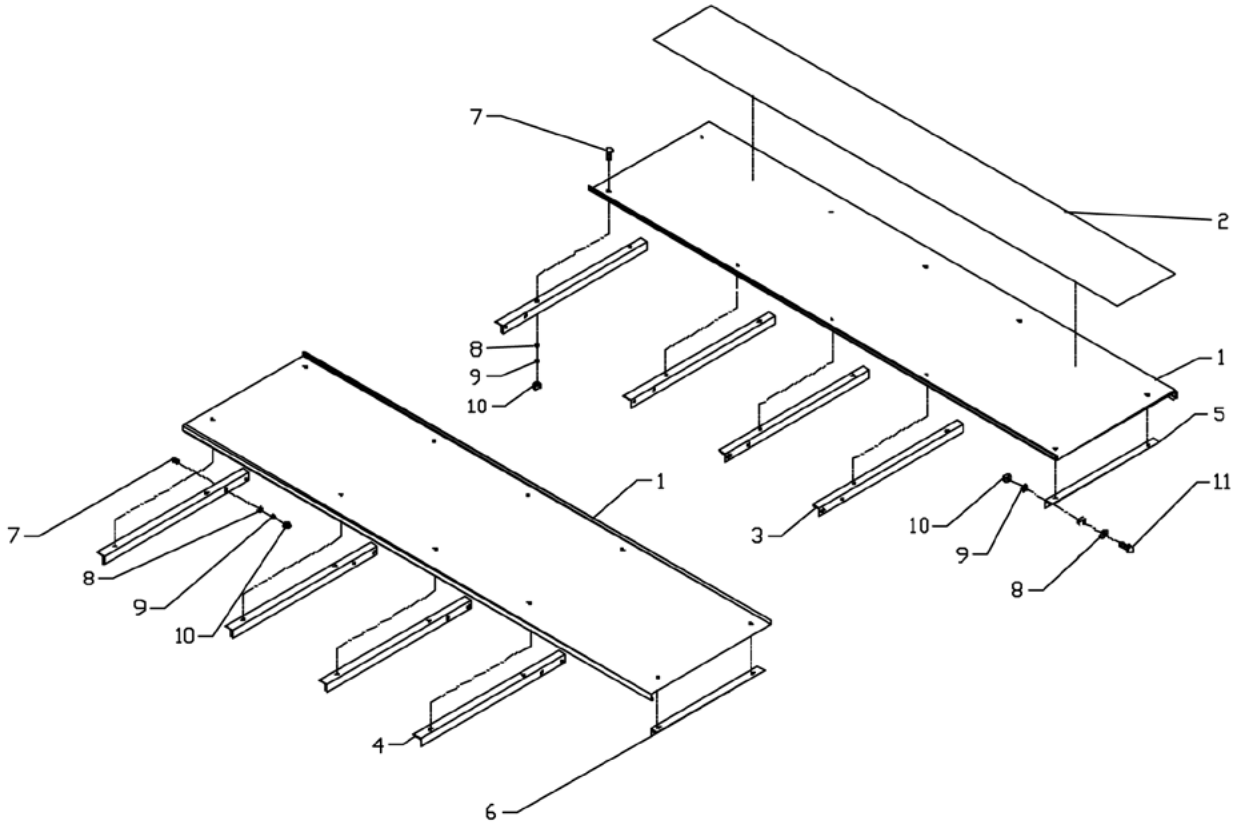

<u>ITEM</u>	<u>PART NO.</u>		<u>DESCRIPTION</u>	<u>QTY</u>
	<u>409</u>	<u>304</u>		
1	81512	81535	Fender – 10' Unit	2
	81513	81536	Fender – 11' Unit	2
	81514	81537	Fender – 12' Unit	2
	81515	81538	Fender – 13' Unit	2
2	21699	21699	Material – Non-Skid, 8" Wide	Inches AR
3	83021-X4	83021-X4	Angle – Fender	AR
4	81499-X1	81499-X1	Angle - Fender	AR
5	71990	71960	Bracket – Mudflap RH	1
6	71991	71961	Bracket – Mudflap LH	1
7	36408	36408	Bolt – Carriage 3/8 x 1	AR
8	36425	36425	Washer – Flat 3/8	AR
9	36420	36420	Washer – Lock 3/8	AR
10	36414	36414	Nut – Hex 3/8	AR
11	36398	36398	Bolt – Carriage 3/8 x 1	4

AR - As Required

PARTS LIST

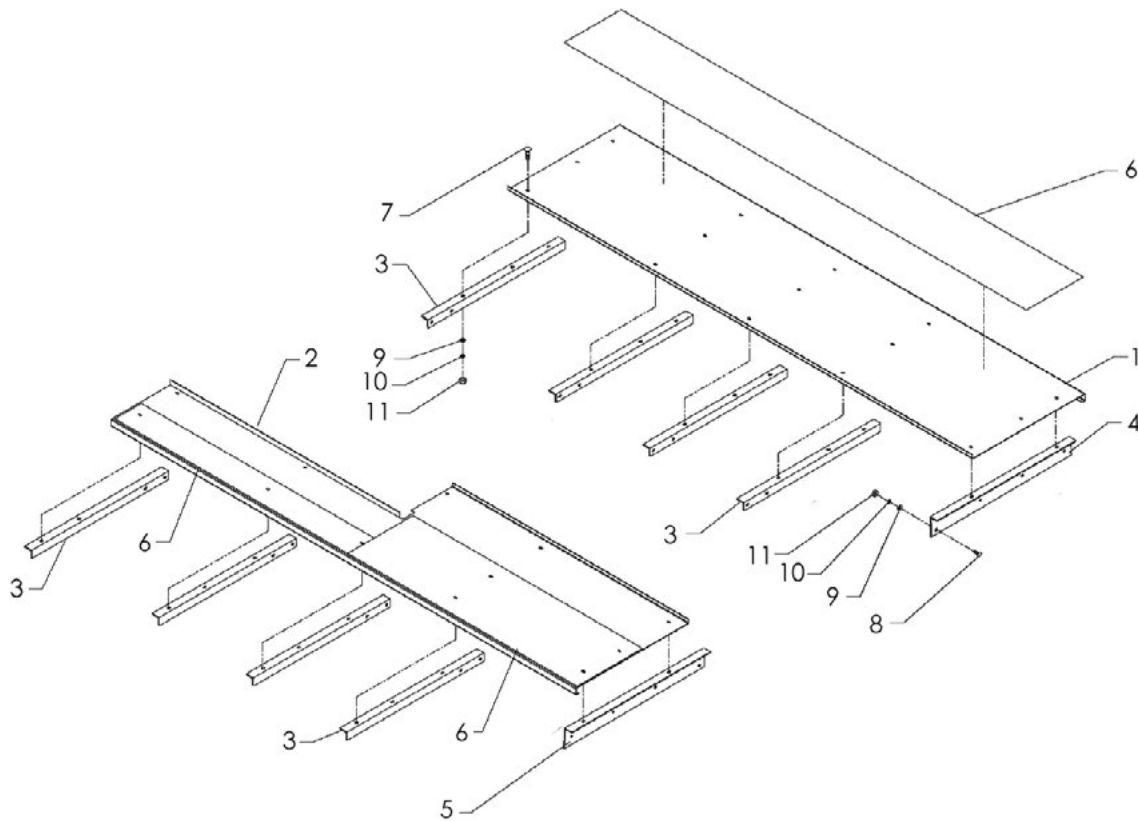

<u>ITEM</u>	<u>PART NO.</u>		<u>DESCRIPTION</u>	<u>QTY</u>
	<u>409</u>	<u>304</u>		
1	81582	81606	Fender – RH 10' Unit	1
	81583	81607	Fender – RH 11' Unit	1
	81584	81608	Fender – RH 12' Unit	1
	81585	81609	Fender – RH 13' Unit	1
2	81720	81742	Fender – LH 10' Unit	1
	81721	81743	Fender – LH 11' Unit	1
	81722	81744	Fender – LH 12' Unit	1
	81723	81745	Fender – LH 13' Unit	1
3	81569-X2	81569-X2	Angle – Fender	AR
4	81597	81621	Bracket - Mudflap RH	1
5	81598	81622	Bracket - Mudflap LH	1
6	21699	21699	Material – Non-Skid, 8" Wide	Inches AR
7	36408	36408	Bolt – Carriage 3/8 x 1	AR
8	36398	39398	Bolt – Carriage 3/8 x 1	4
9	36425	36425	Washer – Flat 3/8	AR
10	36420	36420	Washer – Lock 3/8	AR
11	36414	36414	Nut – Hex 3/8	AR

AR - As Required

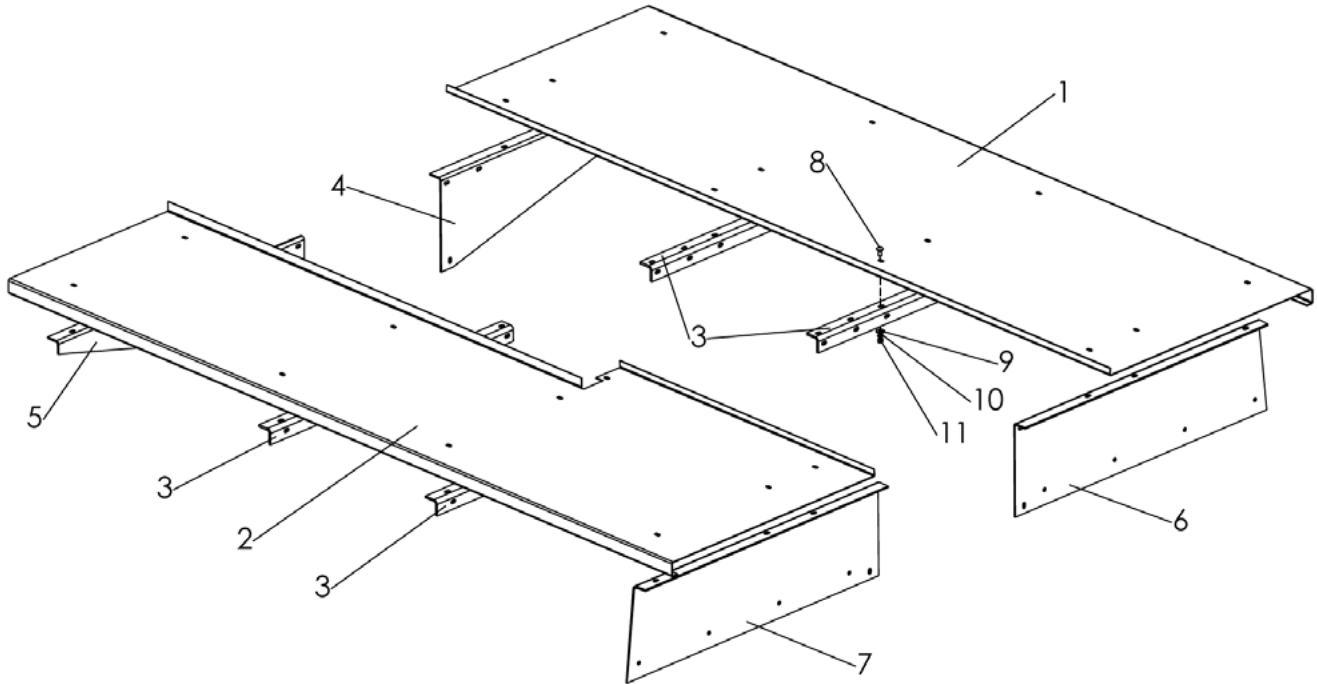

<u>ITEM</u>	<u>PART NO.</u>		<u>DESCRIPTION</u>	<u>QTY</u>
	<u>409</u>	<u>304</u>		
1	87237	81606-X1	Fender – RH 10' Unit	1
	81583-X1	81607-X1	Fender – RH 11' Unit	1
	81584-X1	81608-X1	Fender – RH 12' Unit	1
	81585-X1	81609-X1	Fender – RH 13' Unit	1
2	87238	81742-X1	Fender – LH 10' Unit	1
	81721-X1	81743-X1	Fender – LH 11' Unit	1
	81722-X1	81744-X1	Fender – LH 12' Unit	1
	81723-X1	81745-X1	Fender – LH 13' Unit	1
3	98075	98075	Angle – Mounting	AR
4	83252-X6	83252-X6	Bracket - Fender Front RH	1
5	83253-X7	83253-X7	Bracket - Fender Front LH	1
6	98079	98079	Bracket - Fender & Mudflap RH	1
7	98080	98080	Bracket - Fender & Mudflap LH	1
8	36408	36408	Bolt – Carriage 3/8 x 1	AR
9	36425	36425	Washer – Flat 3/8	AR
10	36420	36420	Washer – Lock 3/8	AR
11	36414	36414	Nut – Hex 3/8	AR
12	*21699	*21699	Material – Non-Skid, 8" Wide	Inches AR

* - Not Shown AR - As Required

PARTS LIST

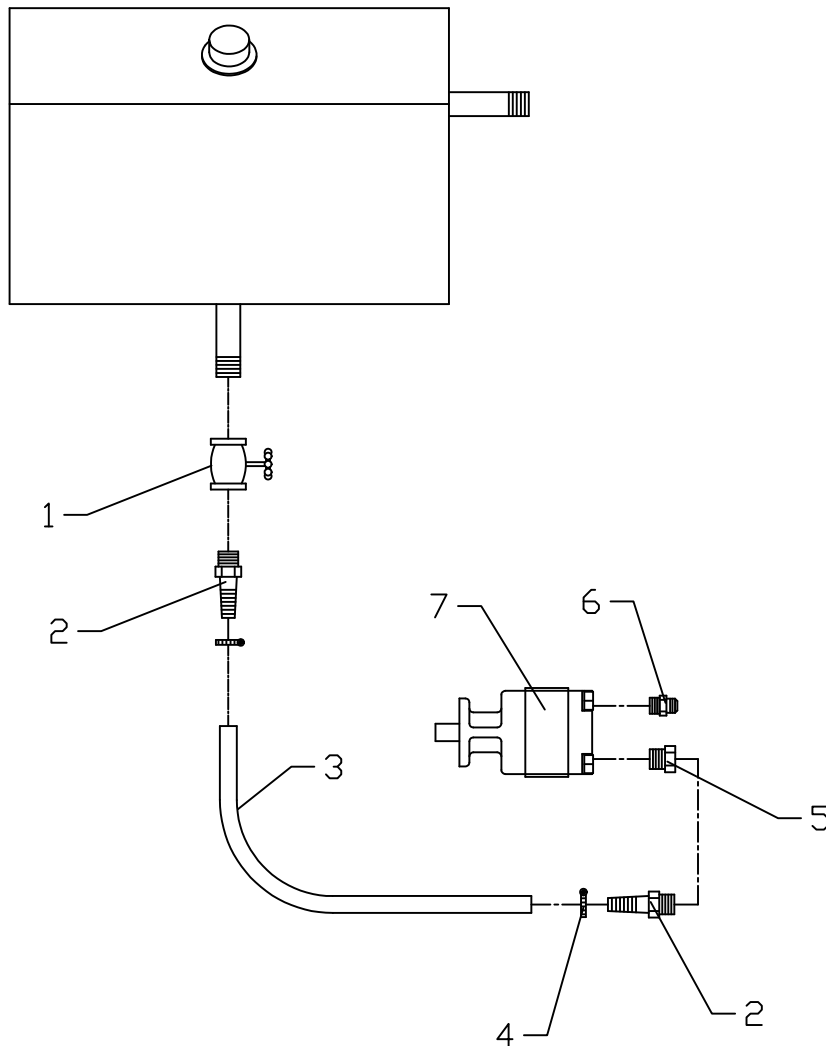

Click or Scan - Relief Valve Setup & Hydraulic Pump Pressure Test Procedure

ITEM	PART NO.	DESCRIPTION	QTY
1	21409	Valve - Gate	1
2	31680	End - Hose	2
3	21878-108	Hose - Direct Mount Pump 1.5 Dia 100R4 Suction	1
4	6288	Clamp	4
5	29780	Bushing	1
6	34845	Adapter	1
7	86664	Pump - 3.85 CID	1
	86665	Pump - 4.38 CID	1
	86664-AH	Seal Kit - Pump	1

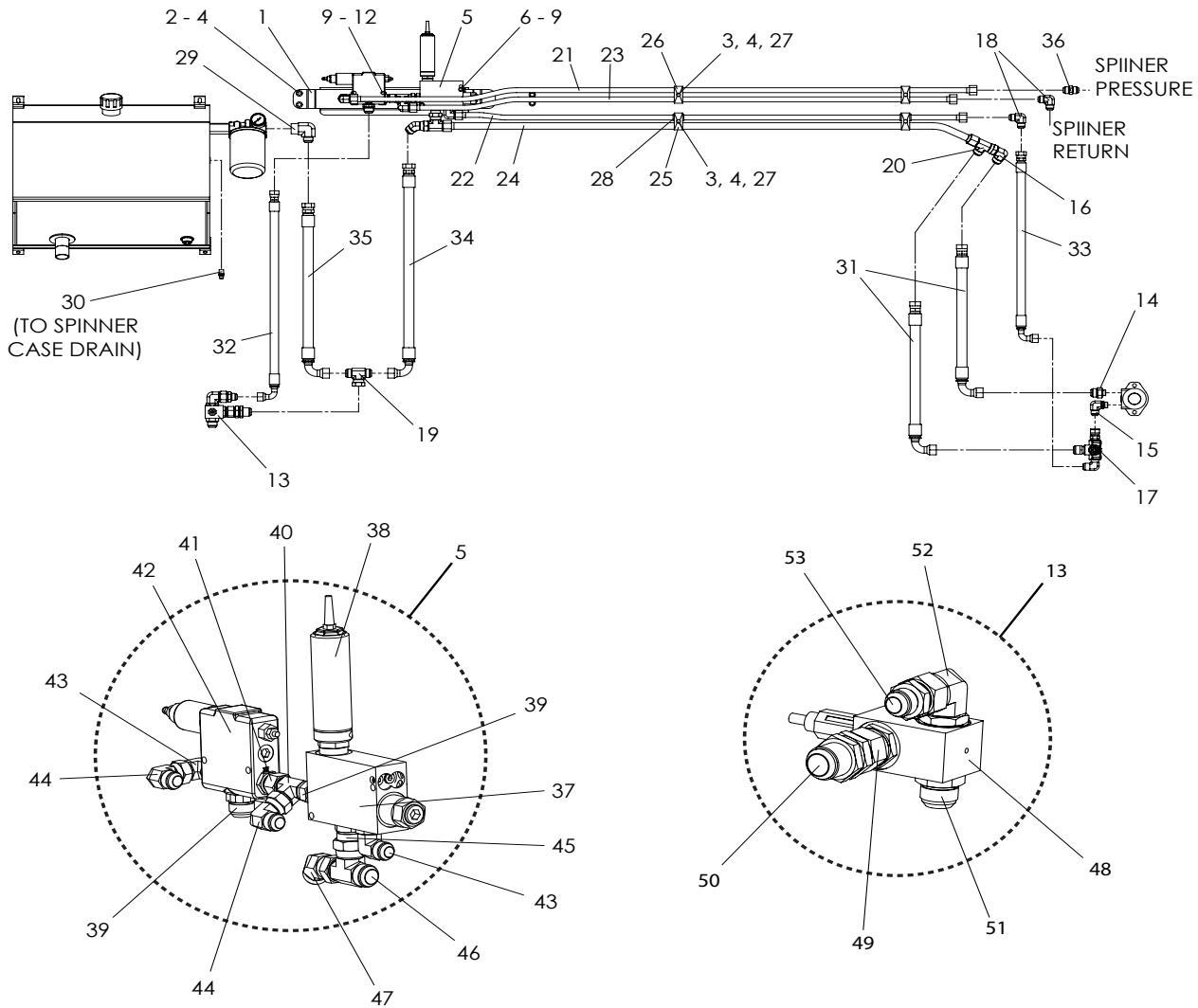

ITEM	PART NO.	DESCRIPTION	QTY
1	307400	Bracket - Valve 9/10' Unit	1
	307401	Bracket - Valve 11' Unit	1
	307402	Bracket - Valve 12' Unit	1
	307403	Bracket - Valve 13' Unit	1
2	34580	Cap Screw - 5/16-18 NC x 1 SS	AR
3	36424	Washer - Flat 5/16	AR
4	42221	Nut - Lock 5/16-18 NC SS	AR
5	307465	Valve - Assy SFP/PWM, Includes Items 37 - 47	1
	306278	Valve - Control Assy, Includes Items 37 & 38	1
6	302098	Washer - Step .25 x 0.4 x 0.5	2

AR - As Required * - Not Shown

PARTS LIST

<u>ITEM</u>	<u>PART NO.</u>	<u>DESCRIPTION</u>	<u>QTY</u>
7	302097	Washer - Step .25 x 0.4 x .13	2
8	56396	Cap Screw - 1/4-20 NC x 3-1/4 SS	2
9	42034	Nut - Lock 1/4-20 SS	4
10	70341-X1	Pipe - Spacer 0.5	2
11	36396	Cap Screw - 1/4-20 NC x 3 SS	2
12	36423	Washer - Flat 1/4 SS	4
13	307466	Valve - Assy Relief, Includes Items 48 - 53	1
14	29778	Fitting - 16-10 070120	1
15	29773	Fitting - 12-10 070220	1
16	29783	Fitting - 16-16 070201	1
17	87336	Valve - Assy Relief	1
18	29785	Fitting - 12-12 070201	2
19	29836	Fitting - 16-16-16 070433	1
20	29850	Fitting - 16-16-16 070432	1
21	305026-AF	Tube - 3/4 x 50 304	1
	305026-AE	Tube - 3/4 x 62 304	1
	305026-AA	Tube - 3/4 x 74 304	1
	305026-AB	Tube - 3/4 x 86 304	1
	305026-AC	Tube - 3/4 x 98 304	1
22	305027-AF	Tube - 3/4 x 34 304	1
	305027-AE	Tube - 3/4 x 46 304	1
	305027-AA	Tube - 3/4 x 58 304	1
	305027-AB	Tube - 3/4 x 70 304	1
	305027-AC	Tube - 3/4 x 82 304	1
23	305028-AF	Tube - 3/4 x 39 304	1
	305028-AE	Tube - 3/4 x 51 304	1
	305028-AA	Tube - 3/4 x 63 304	1
	305028-AB	Tube - 3/4 x 75 304	1
	305028-AC	Tube - 3/4 x 87 304	1
24	313074	Tube - 1 x 37 304	1
	300702	Tube - 1 x 49 304	1
	302407	Tube - 1 x 61 304	1
	302408	Tube - 1 x 72 304	1
	302410	Tube - 1 x 85 304	1
25	300033	Clamp - Tubing Twin 1	AR
26	75036	Clamp - Tubing Twin 3/4	AR
27	71830	Cap Screw - 5/16-18 NC x 2-1/2 SS	AR

AR - As Required * - Not Shown

<u>ITEM</u>	<u>PART NO.</u>	<u>DESCRIPTION</u>	<u>QTY</u>
28	305073	Bushing - Rubber Hose	AR
29	29794	Fitting - 16-20 070202	1
30	29766	Fitting - 6-6 070102	1
31	98666	Hose - Return Assy	2
32	54773	Hose - Assy	1
33	71473	Hose - Assy	1
34	85260	Hose - Return Assy	1
35	82578	Hose - Return Assy	1
36	29817	Fitting - 12-12 070101	1
37	306274	Manifold - 5 - 25 GPM SFP	1
38	306279	Valve - Flow Control 25 GPM	1
39	29789	Fitting - 12-12 070120	2
40	29781	Fitting - 12-12 070432	1
41	29788	Fitting - 12-12 S1040-30 Non-Standard	1
42	32485-X1	Valve - Control PWM	1
43	29847	Fitting - 12-12 070220	2
44	34709	Fitting - 12-12 070221	2
45	305407	Fitting - 16-12 Special Str.	1
46	29836	Fitting - 16-16-16 070433	1
47	29806	Fitting - 16-16 070321	1
48	98109	Valve - Relief Soft Start	1
49	34810	Fitting - 16-16 S1040-30 Non-Standard	1
50	34747	Fitting - 16-16 070601	1
51	29803	Fitting - 16-16 070120	1
52	304819	Fitting - 16-16 Non-Standard 90	1
53	29837	Fitting - 16-12 070101	1

AR - As Required * - Not Shown

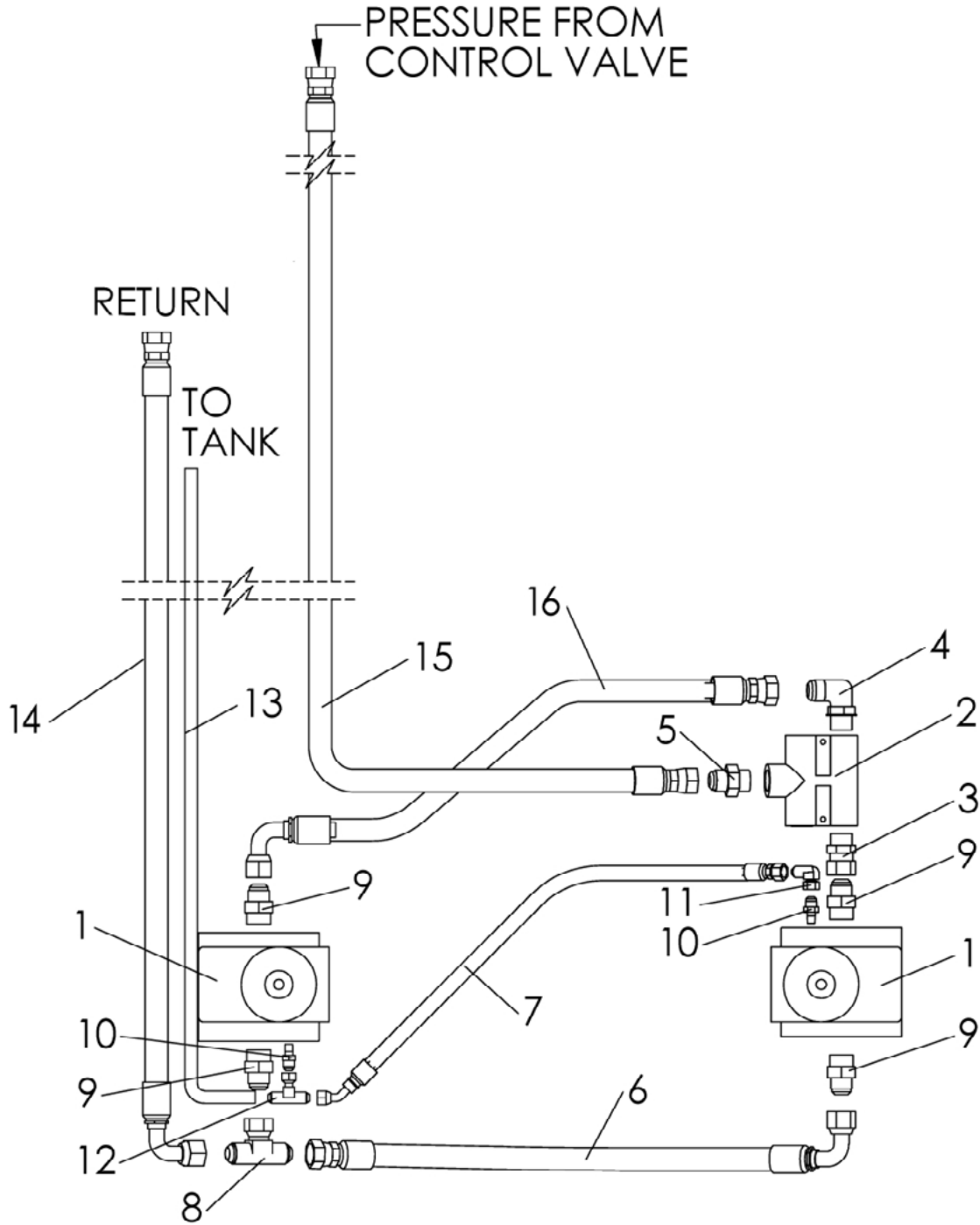

<u>ITEM</u>	<u>PART NO.</u>	<u>DESCRIPTION</u>	<u>QTY</u>
	87098	Motor - LH Style II Assy, Includes 1,8-10,12	
	87099	Motor - RH Style II Assy, Includes 1,9-11	
1	313510	Motor - Spinner	2
	306090	Speedi-Sleeve	1
	306429	Speedi-Tool	1
2	43510	Valve - Flow Divider	1
	56368	Spool - Compensating	1
3	29788	Adapter	1
4	29847	Adapter - 90° Elbow	1
5	29789	Adapter	1
6	87049	Hose Assy	1
7	87112	Hose Assy	1
8	29809	Adapter - Tee	1
9	34717	Adapter - Connector	4
10	34763	Adapter	2
11	34816	Adapter - 90° Elbow	1
12	29825	Adapter - Tee	1
13	313078	Hose - Drain Line 9'	1
	82977	Hose - Drain Line 10'	1
	82978	Hose - Drain Line 11'	1
	82979	Hose - Drain Line 12'	1
	82980	Hose - Drain Line 13'	1
14	87166	Hose - Return Assy	1
15	98713	Hose - Pressure Assy	1
16	98108	Hose - Assy 3/4 x 27-1/2 100R12	

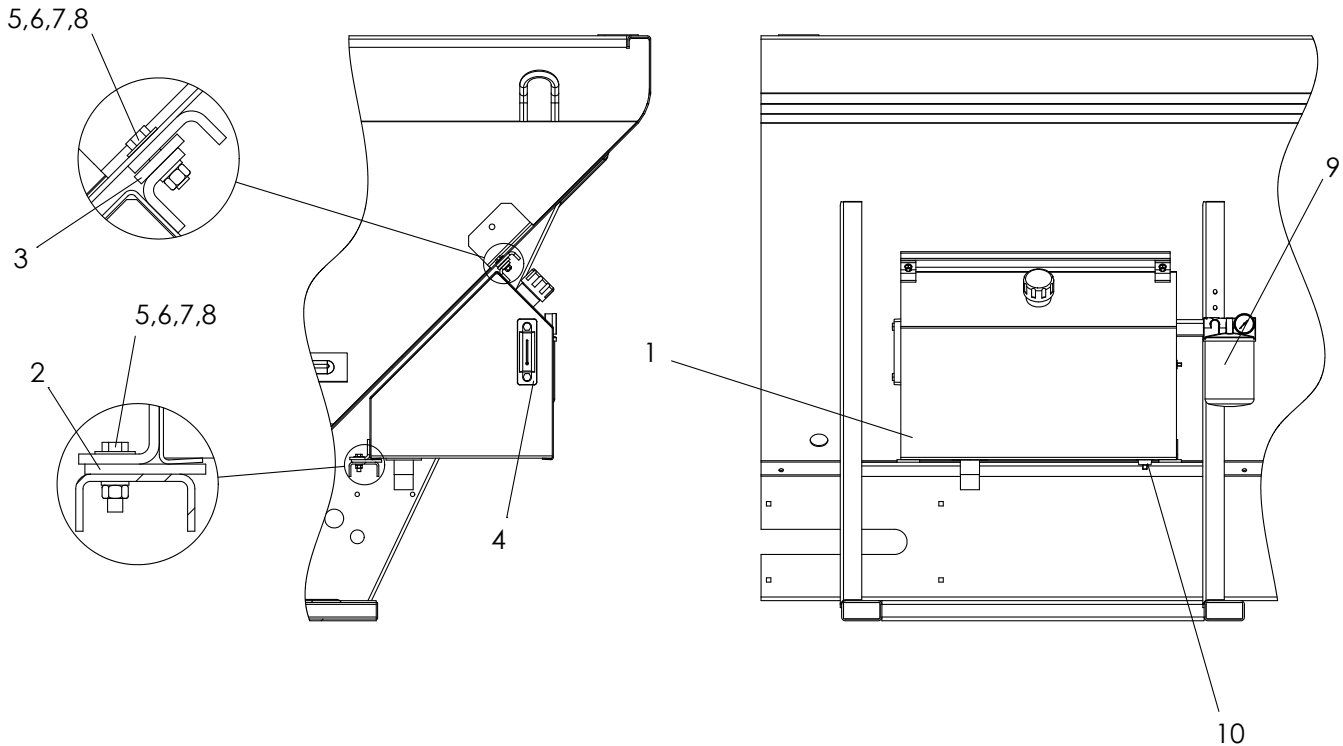

<u>ITEM</u>	<u>PART NO.</u>	<u>DESCRIPTION</u>	<u>QTY</u>
	86468	Tank - Assy 23 Gallon, Includes 1, 9, 10	
	86468-X1	Tank - Assy 23 Gallon, Includes 1, 9, 10	
1	86464	Tank - Wldmt 23 Gallon CS	1
	86464-X1	Tank - Wldmt 23 Gallon 304	1
2	39158	Mount - Flex Belt	2
3	39159	Belt - Flex Mount	2
4	38575	Gauge Assy - Sight & Temp	1
5	34858	Cap Screw - 3/8 x 1 1/2 SS	4
6	36420	Washer - Lock 3/8 SS	4
7	36425	Washer - Flat 3/8 SS	4
8	36414	Nut - Hex 3/8 SS	4
9	39845	Filter - Assy with Indicator	1
	43531	Filter - Element	1
	43532	Seal - Filter	1
	43534	Indicator	1
10	6033	Plug - Pipe 3/4	1

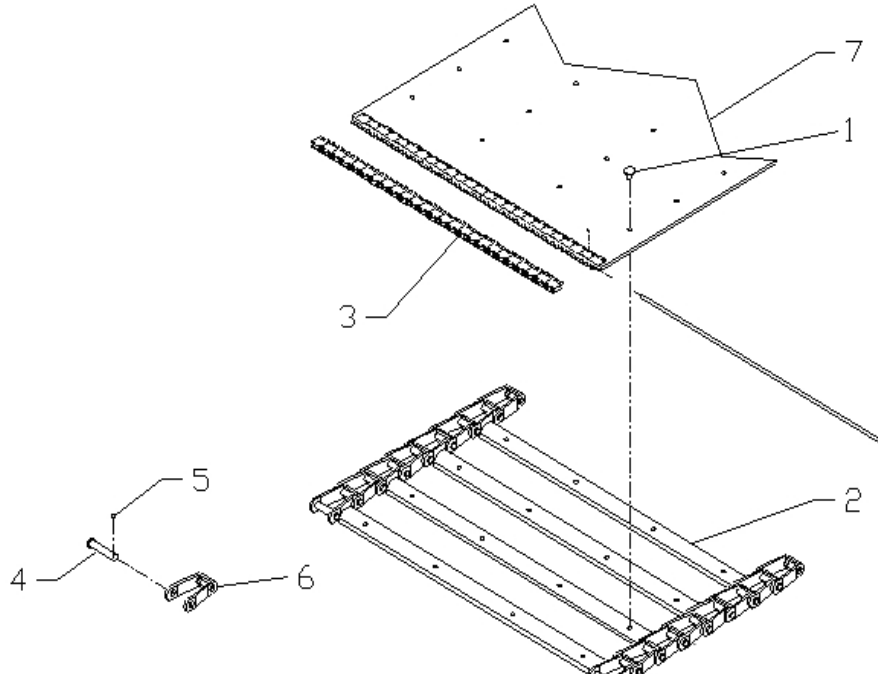

Click or Scan - #4 Belt-Over-Chain Conveyor Replacement Procedure

<u>ITEM</u>	<u>PART NO.</u>	<u>DESCRIPTION</u>	<u>QTY</u>
	305613-AC	10' Unit	1
	305613-AD	11' Unit	1
	305613-AE	12' Unit	1
	305613-AG	13' Unit	1
1	305646	Screw - #4 BOC 1/4 x 9/16 Torx Flat Head	AR
2	305642	Crossbar – Wldmt	AR
3	73317-X1	Kit – Splicer	1
		Lacing Strips 23"	2
		Pin - Connecting	1
		Staples	AR
4	36697	Pin – Pintle Chain	AR
5	20817	Pin – Cotter	AR
6	36699	Link – Pintle Chain	AR
7	56377	Belt – Conveyor (per foot)	AR

AR - As Required

PARTS LIST

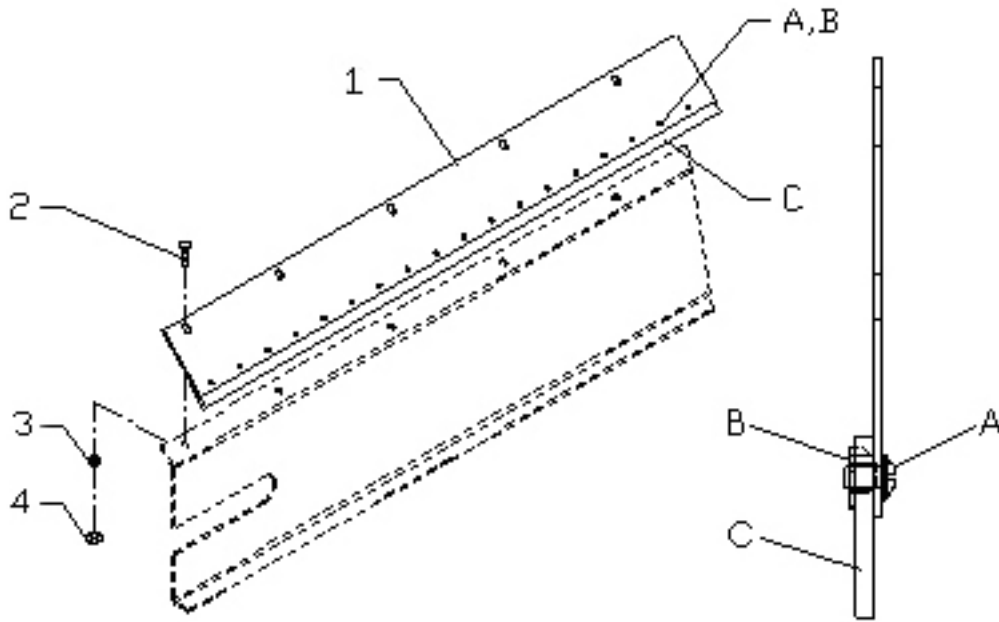

<u>ITEM</u>		<u>PART NO.</u>	<u>DESCRIPTION</u>	<u>QTY</u>
	409 SS	304 SS		
1			Chain Shield – #4 Chain	
	97833	97851	10' Unit	2
	97834	97852	11' Unit	2
	97835	97853	12' Unit	2
	97836	97854	13' Unit	2
A	56258	56258	Screw – Truss Head 1/4 x 1/2	AR
B	88931	88931	Nut – Tee 1/4 x 1/4	AR
C	305975	305975	Sealer - Belt, #4 BOC Shield	AR
			(Specify Unit Length)	
2	71829	71829	Bolt – Carriage 3/8 x 1	AR
3	36420	36420	Washer – Lock 3/8	AR
4	36414	36414	Nut – Hex 3/8	AR

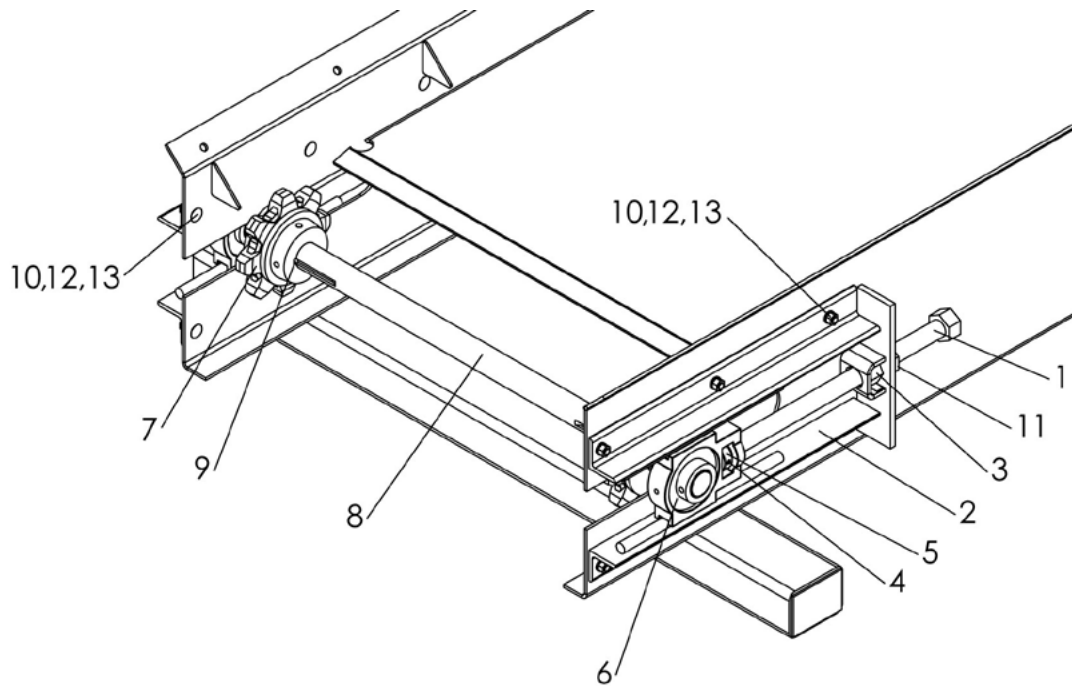

<u>ITEM</u>	<u>PART NO.</u>		<u>DESCRIPTION</u>	<u>QTY</u>
	<u>409</u>	<u>304</u>		
1	36508	36508	Take Up Bolt	2
2	7895	79321	Take-up Wldmt SS	2
3	39110	39110	Nut Wldmt	2
4	20925	20925	Pin – Roll 1/4 x 1 1/2	2
5	30725	30725	Collar – Set 1”	2
6	22511	22511	Bearing – Take-up	2
7	97051	97051	Sprocket – Idler	2
8	48279	48279	Shaft – Idler	1
9	2135	2135	Key – Square 5/16 x 2 1/2	2
10	36414	36414	Nut – Hex 3/8-16NC SS	12
11	36509	36509	Nut – Hex 1-8NC	2
12	36409	36409	Bolt – Carriage 3/8-16NC x 1-1/4 SS	12
13	36420	36420	Washer – Lock 3/8 SS	12

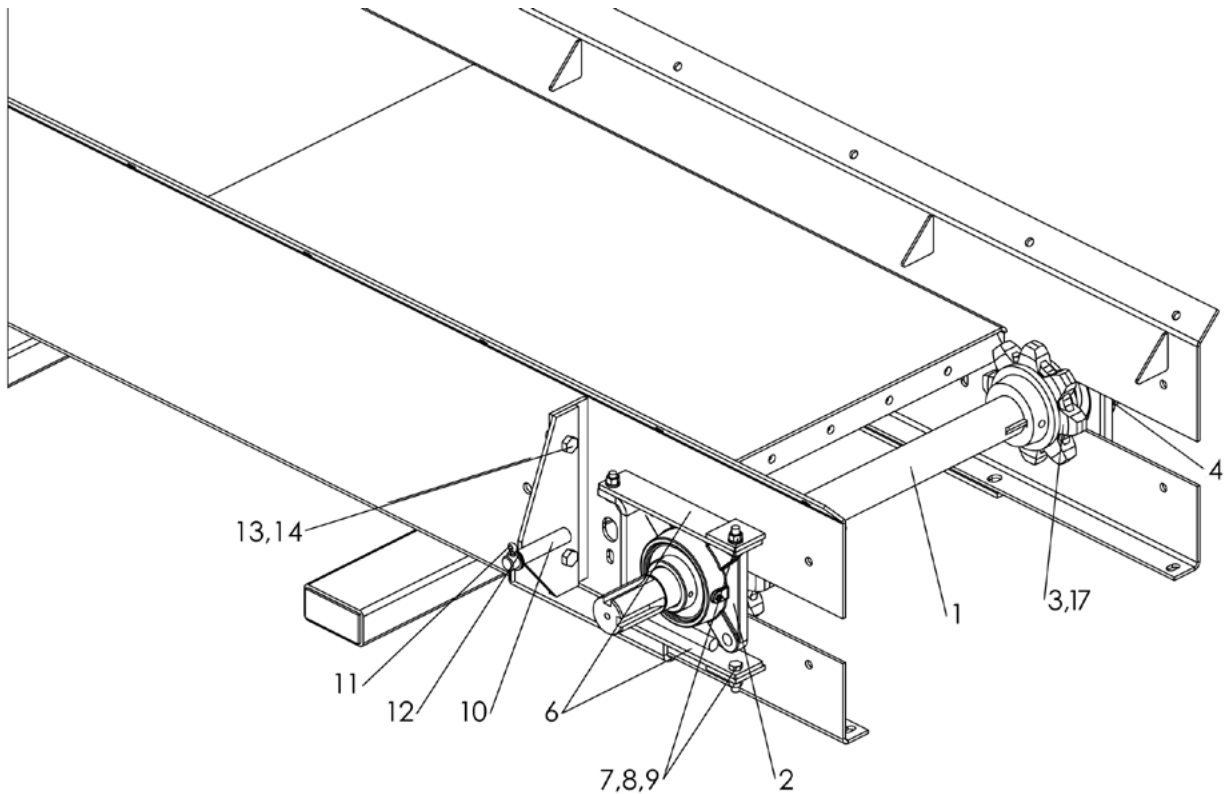

ITEM	PART NO.	DESCRIPTION	QTY
1	77899	Shaft – Drive	1
2	6465	Bearing	2
3	88276	Sprocket	2
4	20743	Screw – Set 5/16 x 3/8	1
5	6131	Key – Square 3/8 x 1 1/2	2
6	82885	Guide – Bearing	4
7	36399	Cap Screw - 3/8 x 1 1/4	8
8	36420	Washer – Lock 3/8	8
9	36414	Nut – Hex 3/8	8
10	82552	Bracket – Torque Arm LH	1
11	20833	Pin – Cotter 1/4 x 1 1/2	1
12	2716	Washer – Flat 3/4	2
13	20128	Cap Screw - 1/2 x 1 1/4	2
14	20680	Nut – Lock 1/2	2
15	*37010	Key – Square 1/2 x 1 1/2	2
16	*57301	Gear Case Assy – see Gear Case Assy page	1
17	56264	Cap - Plug	1

* - Not Shown

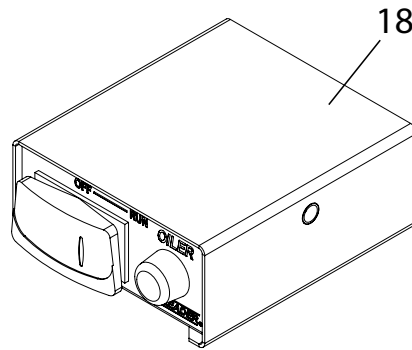
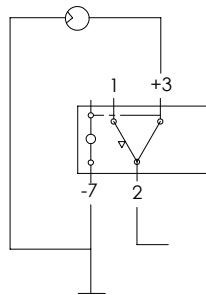
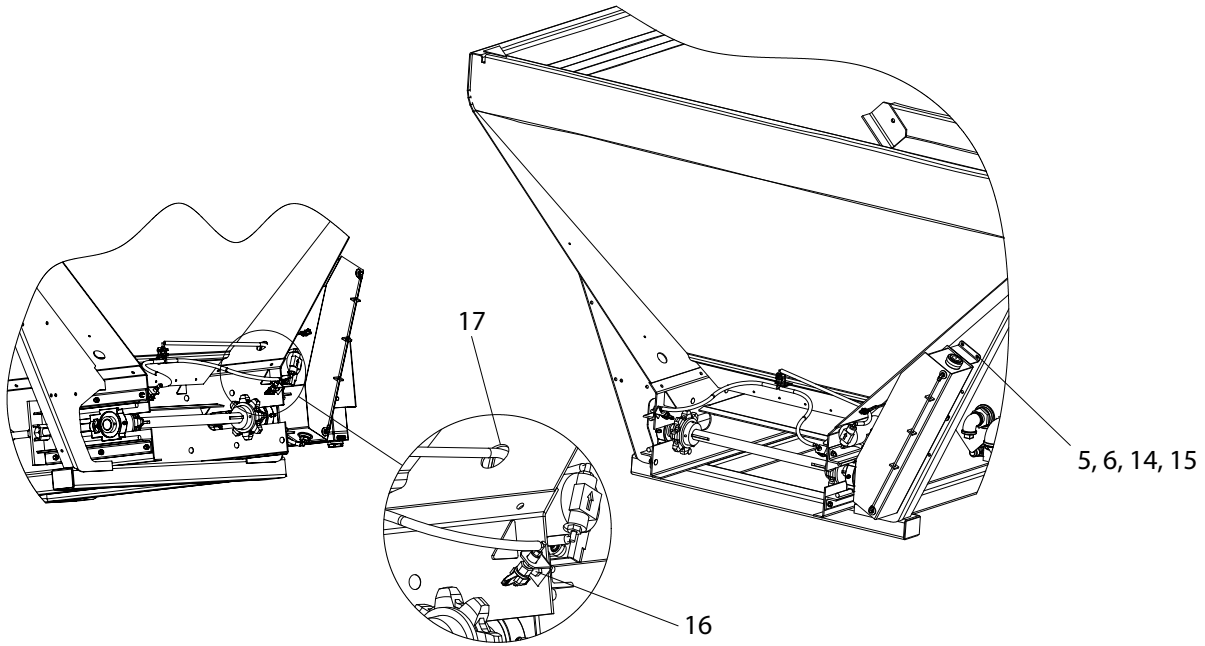
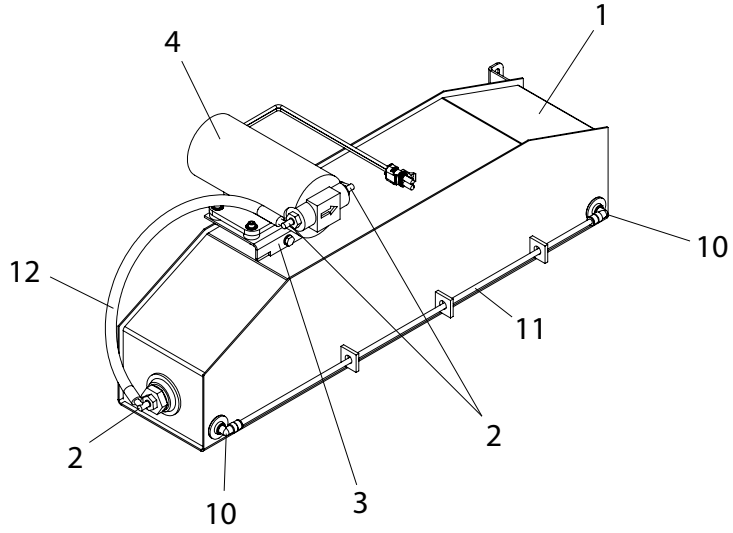
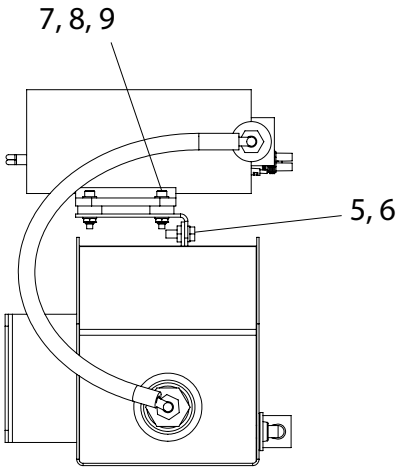

PARTS LIST

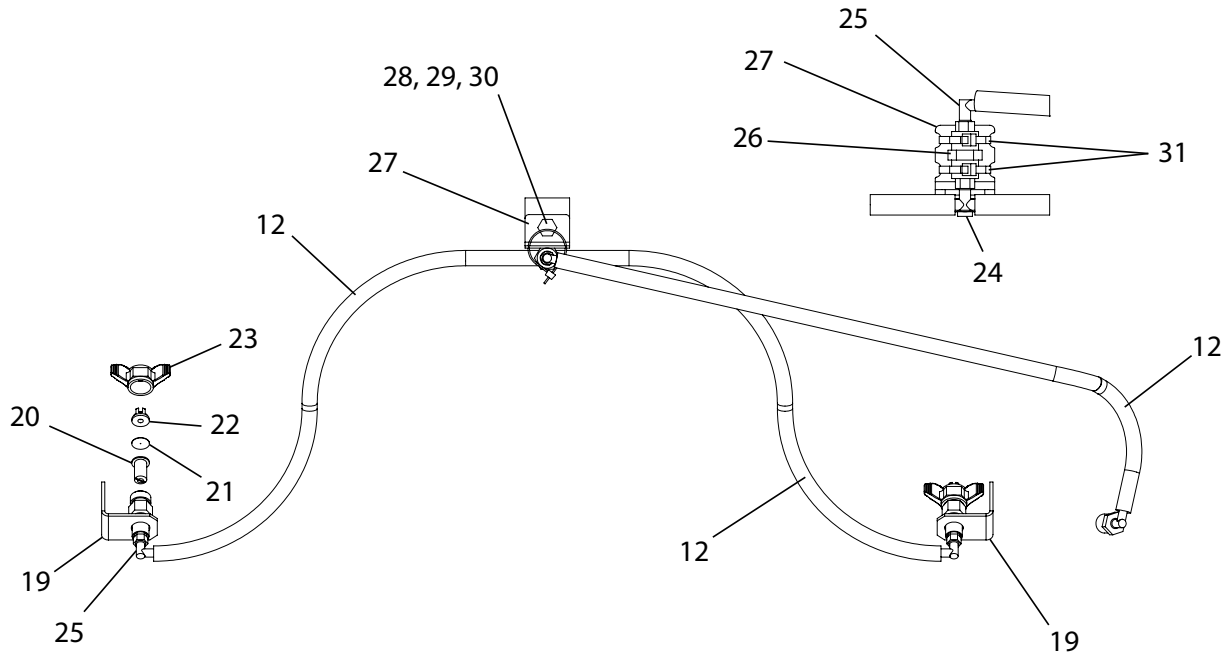

ITEM	PART NO.	DESCRIPTION	QTY
	306063	Tank – Assy, Includes 1-13	
	306658	Nozzle & Hose - Assy, Includes 12,13,19-29	
1	304398	Tank – Wldmt	1
2	306657	Elbow	3
3	304409	Mount – Pump	1
4	304390	Pump – Assy with Connector	1
	304834	Pump – Diaphragm 1.1 GPM 30 PSI	1
	303730-AB	Connector – FEM Socket Sealed	1
	303730-CC	Terminal – FEM Sealed (Sleeve)	2
	303730-EB	Seal – Cable Lt Gray	2
5	36393	Cap Screw - 1/4-20 NC x 3/4 SS	5
6	36418	Washer – Lock 1/4 SS	5
7	44454	Screw - Socket Head #10-24 NC x 1 SS	4
8	171052	Washer – Flat #10 SS	8
9	56355	Nut - Hex Lock #10-24 NC SS	4
10	301337	Fitting – 90 Male 1/8 NPT	2
11	306437	Tubing – Clear	Feet 1.167
12	26544	Hose – Low Pressure 1/4” ID	Feet 5.5
13	*306670	Tape – Thread Seal w/PTFE Yellow Gas Line	AR
14	36423	Washer - Flat 1/4 SS	8
15	36412	Nut - Hex 1/4-20 NC SS	4

Please Give Part No., Description & Unit Serial No.



<u>ITEM</u>	<u>PART NO.</u>	<u>DESCRIPTION</u>	<u>QTY</u>
16	36399	Cap Screw – 3/8-16 NC x 1-1/4 SS	2
17	34129	Grommet – Rubber	1
18	304391	Panel – Assy Oiler Control	1
	99676	Fuse – 10AMP Fast Acting	1
19	306649	Nozzle – Mount Assy	2
	304839	Angle – Wldmt Nozzle Mount	1
	306650	Body – Male Nozzle Brass	1
20	306651	Strainer – Check Valve	2
21	306652	Plate – Orifice SS	2
22	306654	Nozzle – Even Flat Spray SS	2
23	306653	Cap – Nozzle	2
24	306655	Tee – Black	1
25	306656	Elbow – Black	3
26	306678	Coupling – Polypropylene	1
27	306804	Bracket – Coupling	1
28	36293	Cap Screw – 3/8-16 NC x 3/4 SS	1
29	36420	Washer – Lock 3/8 SS	1
30	36414	Nut - Hex 3/8-16 NC SS	1
31	99674	Tie - Wire	2

* - Not Shown AR – As Required

This page is intentionally left blank.

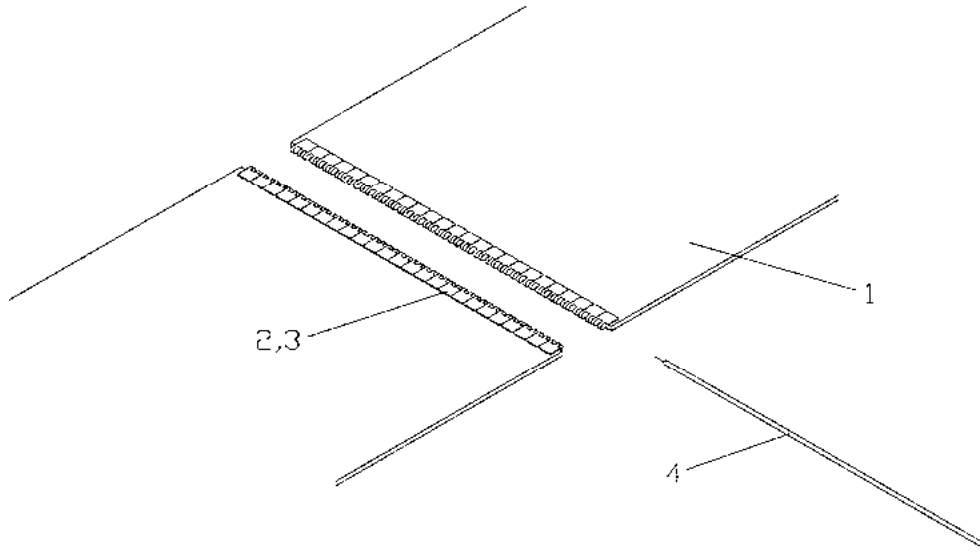

Click or Scan - #5 Straight Belt Conveyor Tensioning & Tracking Procedure

<u>ITEM</u>	<u>PART NO.</u>	<u>DESCRIPTION</u>	<u>QTY</u>
	305307-AB	Conveyor - Assy #5 9' Unit	1
	305307-AC	Conveyor - Assy #5 10' Unit	1
	305307-AD	Conveyor - Assy #5 11' Unit	1
	305307-AE	Conveyor - Assy #5 12' Unit	1
	305307-AG	Conveyor - Assy #5 13' Unit	1
1	305300-AB	Belt - Conveyor 9' Unit	1
	305300-AC	Belt - Conveyor 10' Unit	1
	305300-AD	Belt - Conveyor 11' Unit	1
	305300-AE	Belt - Conveyor 12' Unit	1
	305300-AG	Belt - Conveyor 13' Unit	1
	33884	Tape - Belt (per foot)	AR
2	53992	Fastener - Assy 1-Bolt	4
	53993	Fastener - Assy 2-Bolt	2
	53994	Fastener - Assy 3-Bolt	4
3	39604-23	Tube - Plastic	2
4	39603	Pin - Hinge	1

AR - As Required

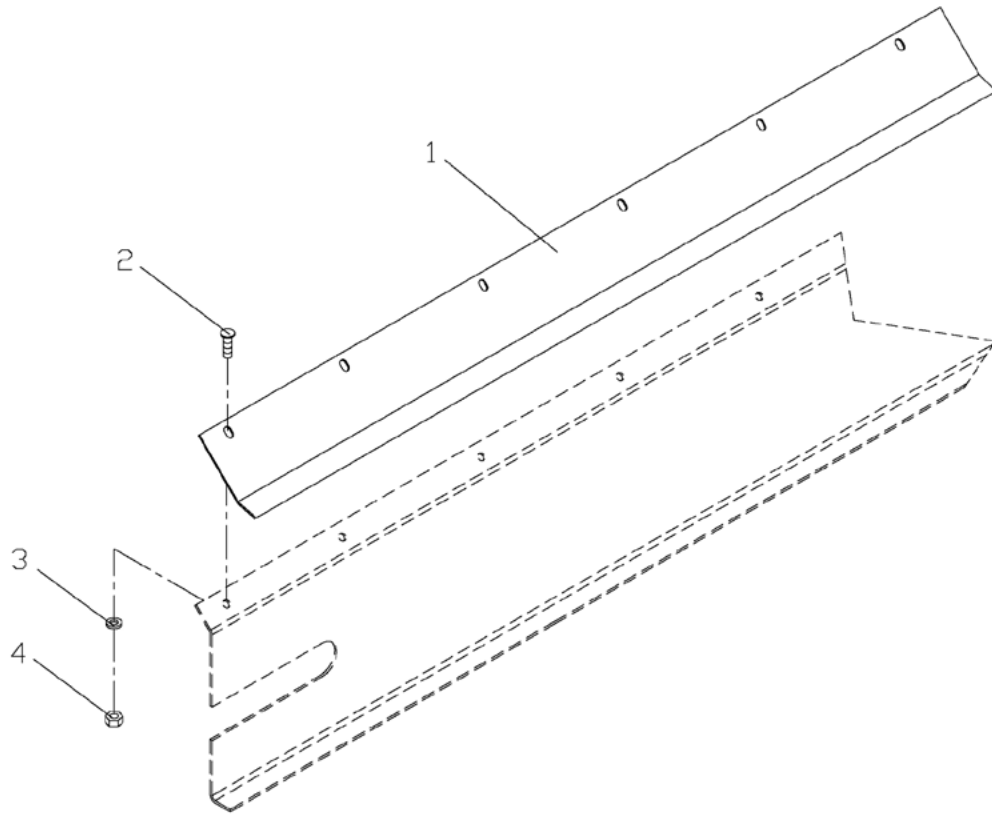

<u>ITEM</u>		<u>PART NO.</u>	<u>DESCRIPTION</u>	<u>QTY</u>
	409 SS	304 SS		
1			Shield – #5 Belt	
	97730-AB	--	9' Unit RH	1
	97730-AF	--	9' Unit LH	1
	97730-AC	97747-AC	10' Unit	2
	97730-AD	97747-AD	11' Unit	2
	97732-AA	97749-AA	12' Unit	2
	97732-AB	97749-AB	13' Unit	2
2	71829	71829	Bolt – Carriage 3/8 x 1	AR
3	36420	36420	Washer – Lock 3/8	AR
4	36414	36414	Nut – Hex 3/8	AR

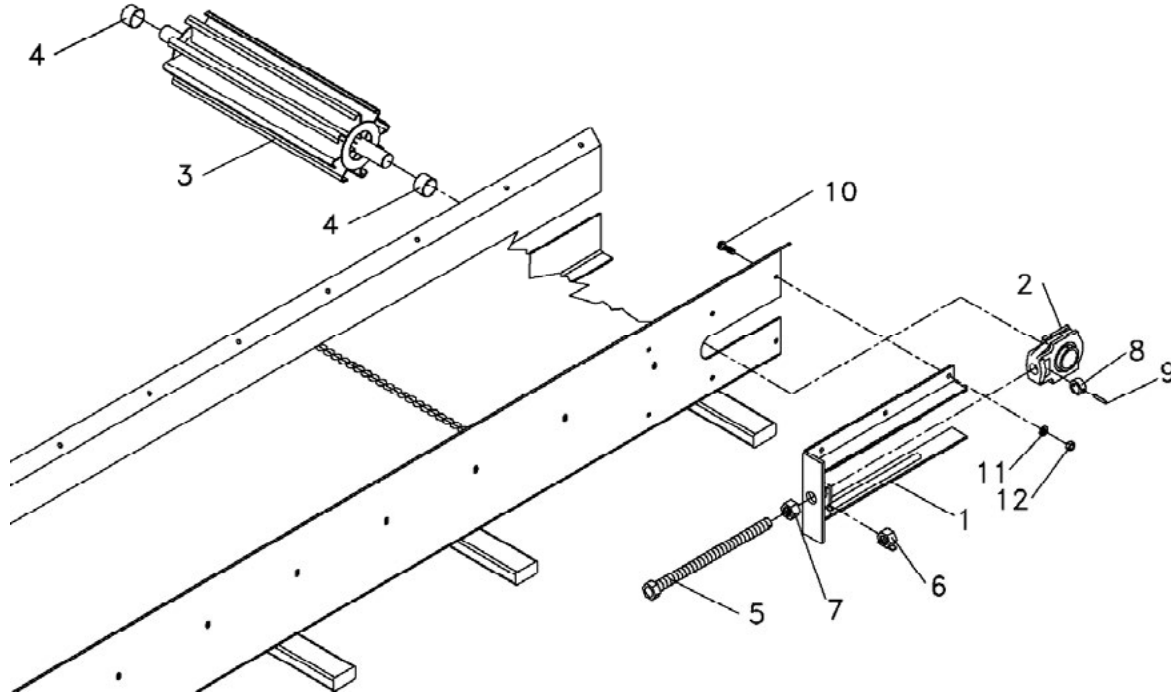

ITEM	PART NO.		DESCRIPTION	QTY
	409	304		
1	7895	79321	Take-up – Wldmt	2
2	22511	22511	Bearing – Take-up	2
3	81968	81976	Pulley - Wldmt Idler	1
4	81345	81345	Spacer – Pipe Idler Pulley	2
5	36508	36508	Tightener – Chain Wldmt	2
6	39110	39110	Nut Wldmt	2
7	36509	36509	Nut – Hex 1-8NC SS	2
8	30725	30725	Collar – Set 1”	2
9	20925	20925	Pin – Roll 1/4 x 1-1/2	2
10	36409	36409	Bolt – Carriage 3/8 x 1-1/4 SS	12
11	36420	36420	Washer – Lock 3/8 SS	12
12	36414	36414	Nut – Hex 3/8 SS	12
13	*20737	*20737	Screw - Set 1/4-20NC x 1/2	1

* - Not Shown

PARTS LIST

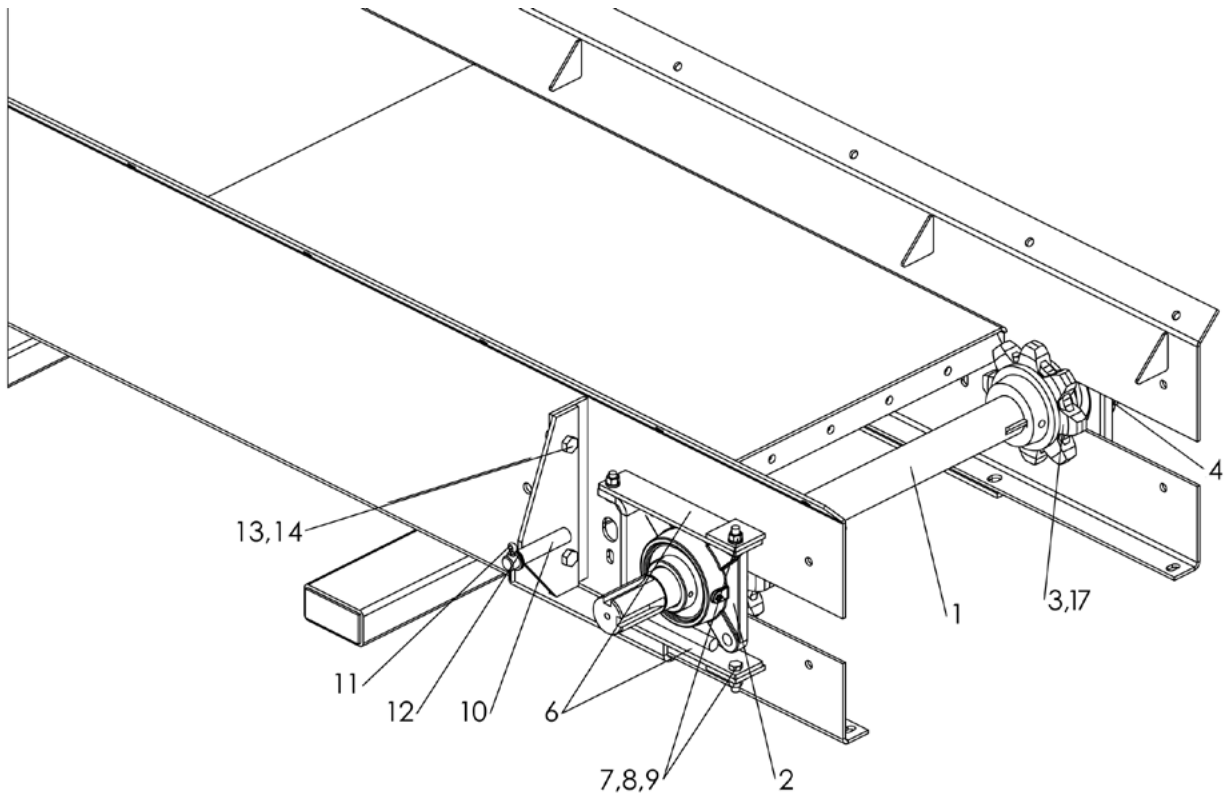

ITEM	PART NO.	DESCRIPTION	QTY
1	77899	Shaft – Drive	1
2	6465	Bearing	2
3	88276	Sprocket	2
4	20743	Screw – Set 5/16 x 3/8	1
5	6131	Key – Square 3/8 x 1 1/2	2
6	82885	Guide – Bearing	4
7	36399	Cap Screw - 3/8 x 1 1/4	8
8	36420	Washer – Lock 3/8	8
9	36414	Nut – Hex 3/8	8
10	82552	Bracket – Torque Arm LH	1
11	20833	Pin – Cotter 1/4 x 1 1/2	1
12	2716	Washer – Flat 3/4	2
13	20128	Cap Screw - 1/2 x 1 1/4	2
14	20680	Nut – Lock 1/2	2
15	*37010	Key – Square 1/2 x 1 1/2	2
16	*57301	Gear Case Assy – see Gear Case Assy page	1
17	56264	Cap - Plug	1

* - Not Shown

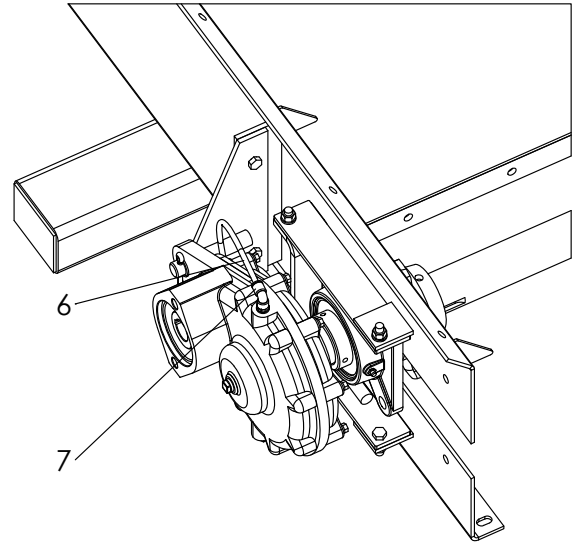
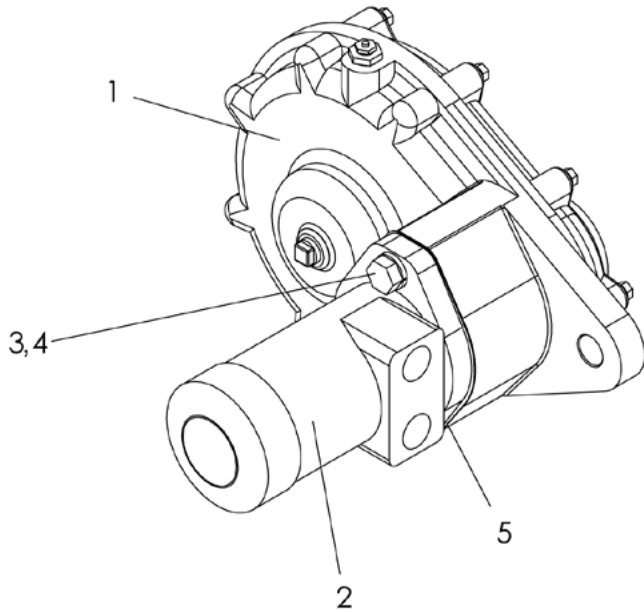

<u>ITEM</u>	<u>PART NO.</u>	<u>DESCRIPTION</u>	<u>QTY</u>
	57301	Gear Case - Assy, Includes 1-5	
1	36671	Gear Case – Single	1
2	38897	Motor – Hydraulic, 1-1/2"	1
3	20129	Cap Screw – 1/2 x 1-1/2	2
4	20714	Washer – Lock 1/2	2
5	74524	Gasket – Motor Flange	1
6	306891	Fitting - 4-2 630202K	1
7	9005-0-7761	Tubing - 1/4 OD Air Brake Black	ft 1.5

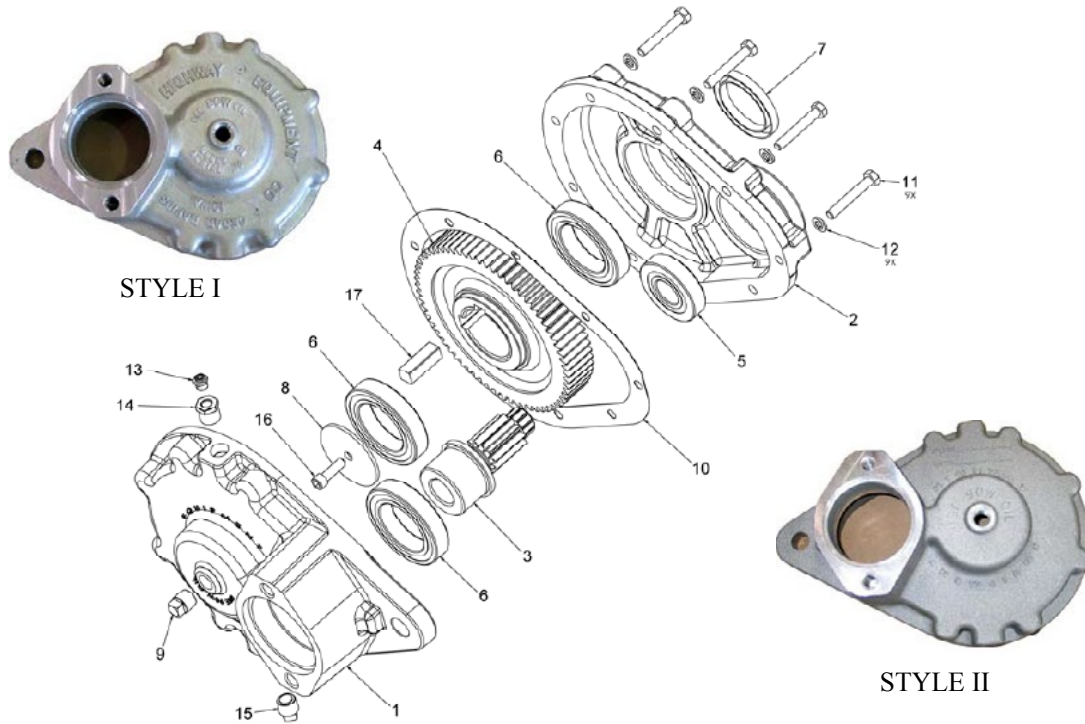

ITEM	PART NO.		DESCRIPTION	QTY
	36671		Gear Case – Single Pinion	
	Style I	Style II		
	304269-AA	304269-AB	Parts – Service, Includes 1–17	
1	37001	304559	Housing – Outboard	1
2	37002	304560	Housing – Inboard	1
3	37003	304561	Gear – Pinion 11 Tooth	2
4	38981	304562	Gear – Driven 67 Tooth	1
5	37007	37007	Bearing	2
6	37008	37008	Bearing	4
7	37006	37006	Seal – Oil	1
8	38979	38979	Washer – Flat 2-1/2 x 11/32	2
9	6031	6031	Plug – Pipe	1
10	37005	304563	Gasket – Housing	1
11	20040	20040	Cap Screw – 5/16NC x 2	10
12	20711	20711	Washer – Lock 5/16	10
13	2564	2564	Cap – Breather	1
14	27465	27465	Bushing – Pipe 1/8 x 3/8	1
15	21490	21490	Plug – Pipe Magnetic	1
16	38980	38980	Screw – Allen Head 5/16-18 x 1	1
17	37010	37010	Key – 1/2 x 1/2 x1-1/2	2

#4 BOC Conveyor

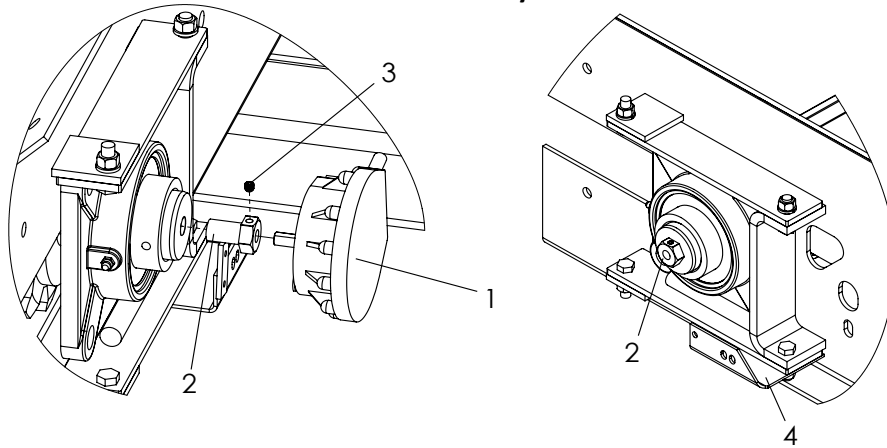

#5 Belt Conveyor

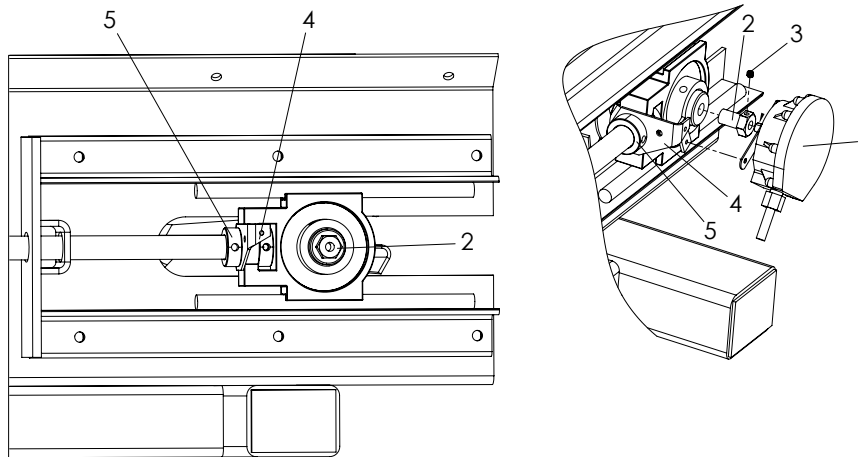

Click or Scan - Encoder Test Procedure



Click or Scan - Encoder Installation Procedure

ITEM	PART NO.		DESCRIPTION	QTY
	#4 BOC	#5 Belt		
1	303994	303994	Encoder – 180 with Hardware	1
	304056	304056	Encoder - 360 with Hardware	1
2	310601	310601	Coupler - Rate Sensor SS	1
3	310603	310603	Screw - Set 1/4-20NC x 5/16 SS	1
4	304946	81949	Bracket - Sensor	1
5	--	2696	Collar - Set	

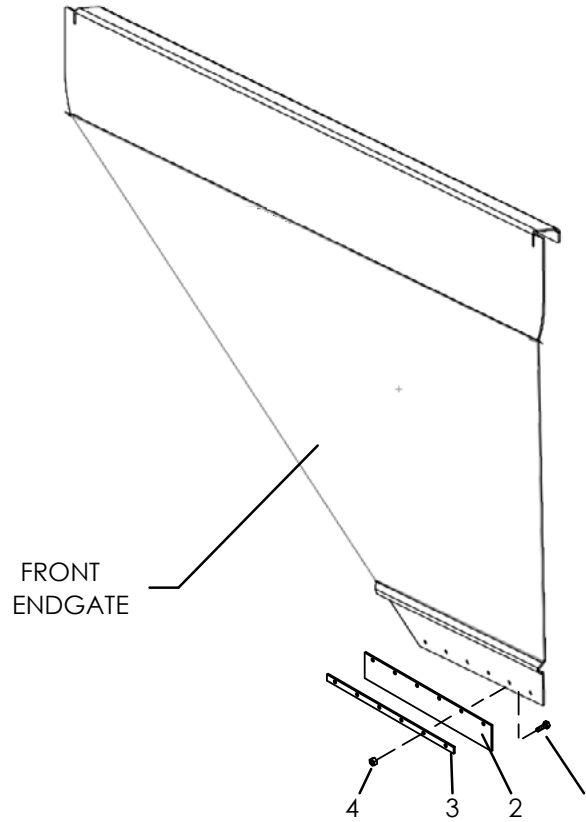

<u>ITEM</u>	<u>PART NO.</u>	<u>DESCRIPTION</u>	<u>QTY</u>
1	32446	Screw – Machine 1/4 x 3/4	5
2	39426	Wiper – Belt	1
3	54230	Retainer – Belt	1
4	36412	Nut – Hex 1/4	5

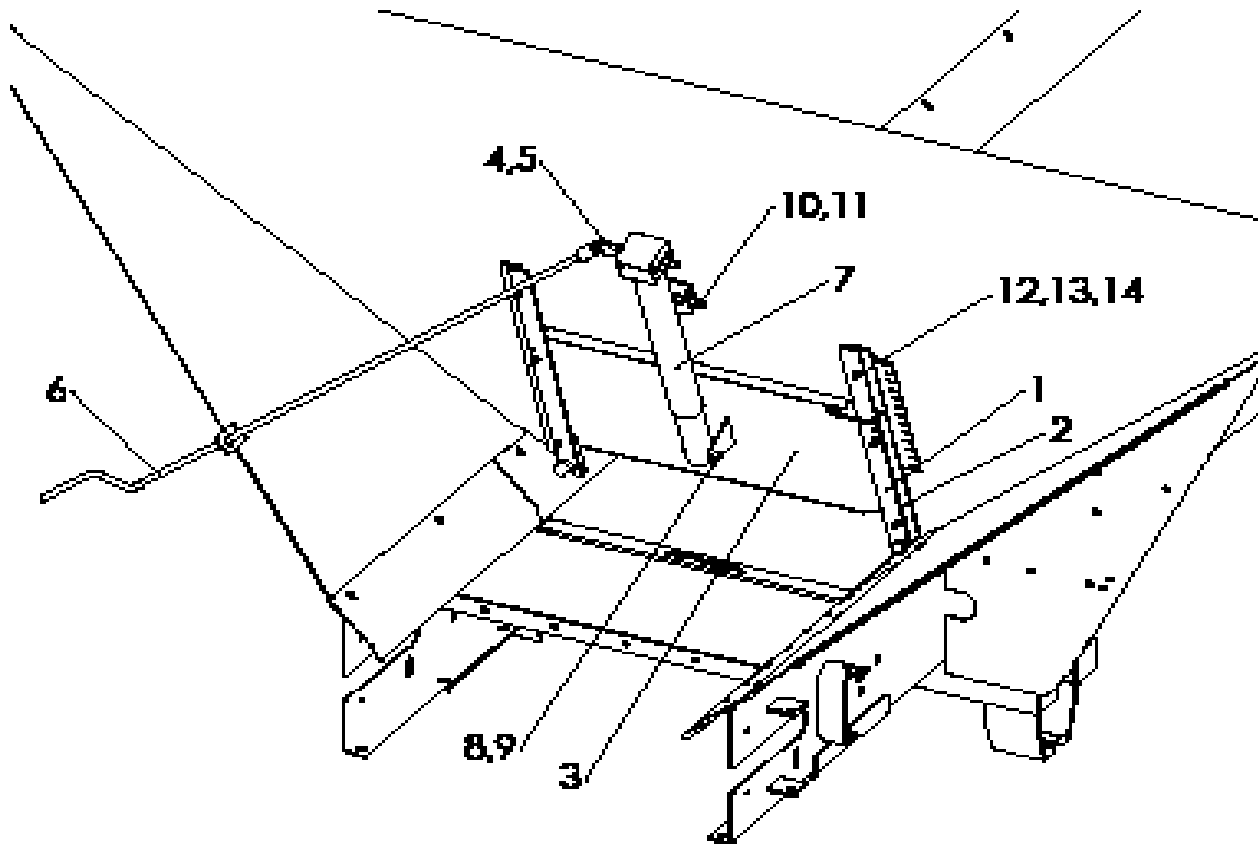

<u>ITEM</u>	<u>PART NO.</u>	<u>DESCRIPTION</u>	<u>QTY</u>
1	36384	Slide – Feedgate	2
2	36385	Guide – Feedgate	2
3	98509	Feedgate – Wldmt 409	1
	303937-AB	Feedgate - Wldmt 304	1
4	85002	U-Joint	1
5	20918	Pin – Roll	2
6	307476	Handle	1
7	40704	Jack - Feedgate	1
8	71827	Cap Screw – 3/8-16NC x 3	1
9	72054	Nut – Lock 3/8	1
10	80798	Cap Screw – 1/2 x 3 3/4	1
11	39016	Nut – Hex 1/2	1
12	40750	Cap Screw – 1/4 x 1 1/4	6
13	36418	Washer – Lock 1/4	6
14	36412	Nut – Hex 1/4	6

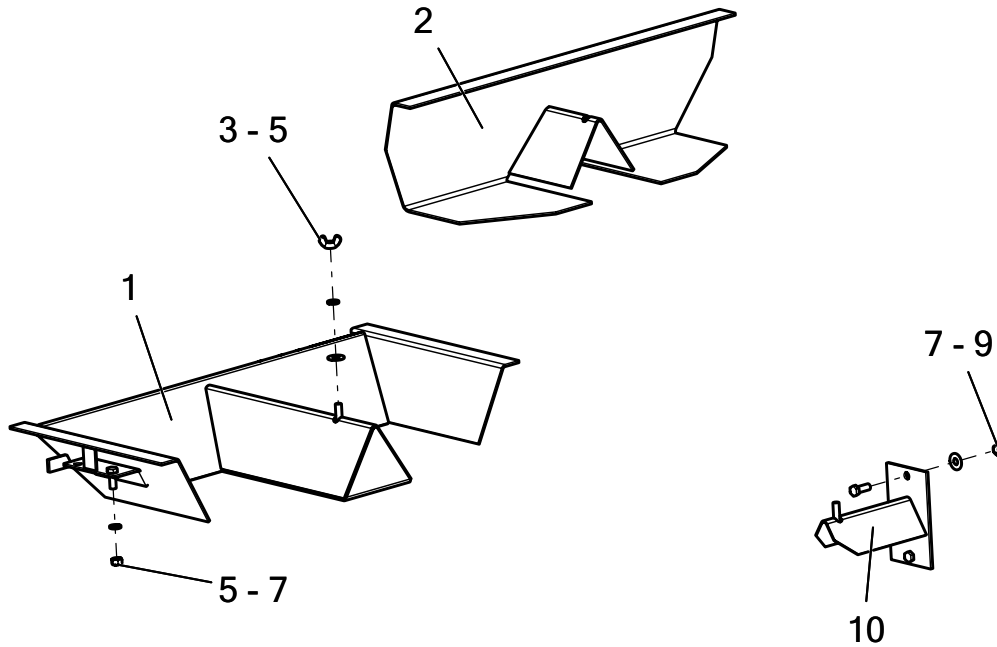

<u>ITEM</u>	<u>PART NO.</u>	<u>DESCRIPTION</u>	<u>QTY</u>
	87107	Divider – Material Assy, Includes 1-5	
1	87037	Divider – Wldmt	1
2	87045	Deflector – Rear Wldmt	1
3	20673	Nut – Wing 3/8 SS	1
4	36425	Washer – Flat 3/8 SS	1
5	36420	Washer – Lock 3/8 SS	1
6	36293	Cap Screw – 3/8-16NC x 3/4 SS	2
7	36414	Nut – Hex 3/8-16NC SS	AR
8	36398	Cap Screw - 3/8-16NC x 1 SS	2
9	36425	Washer - Flat 3/8 SS	2
10	87381	Mount - Divider Storage Wldmt SS	1

AR - As Required

PARTS LIST

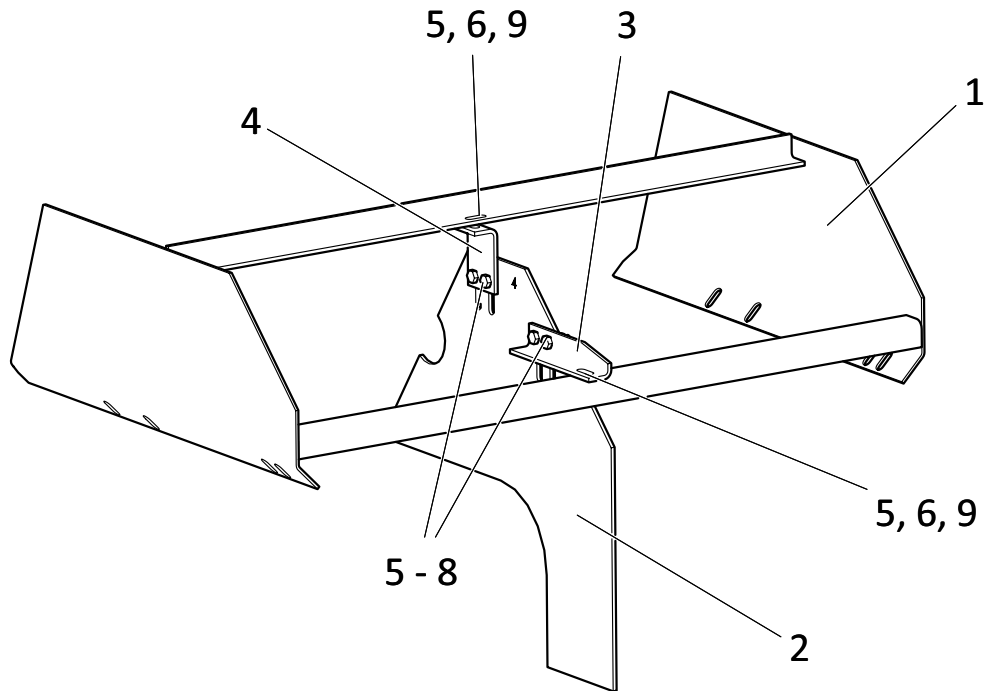

<u>ITEM</u>	<u>PART NO.</u>	<u>DESCRIPTION</u>	<u>QTY</u>
1	56926	Bracket – Wldmt Support	1
2	82288	Panel - Divider #4 BOC	1
	56878	Panel - Divider #5 Belt	1
3	56879	Bracket – Clamp	1
4	56880	Angle – Clamp	1
5	34580	Cap Screw – 5/16 x 1	6
6	36424	Washer – Flat 5/16	8
7	36419	Washer – Lock 5/16	4
8	36413	Nut – Hex 5/16	4
9	42221	Nut – Lock 5/16	2

Note: Use chain shield hardware to attach Item 1 to sills.

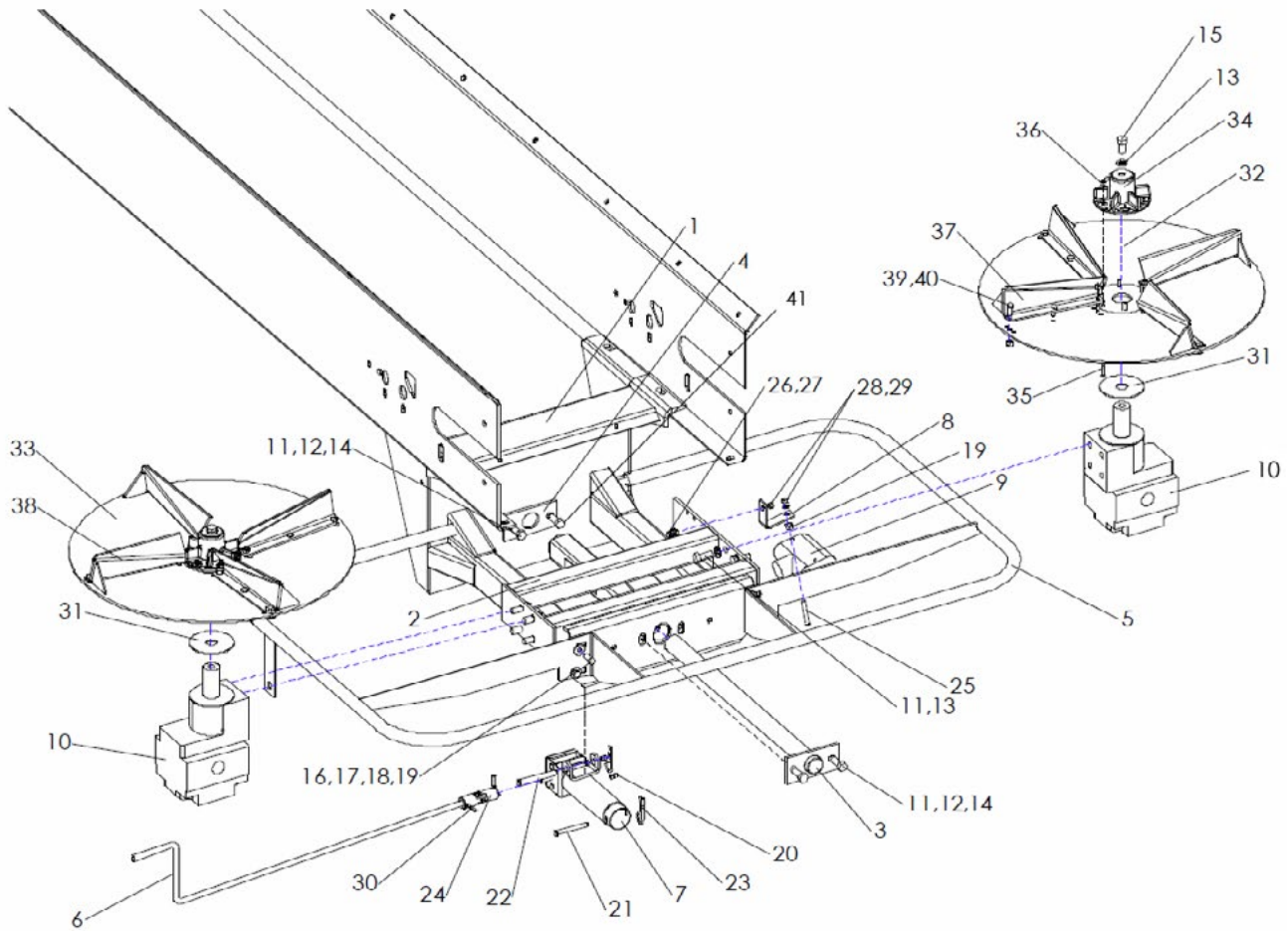

PARTS LIST

ITEM	PART NO.	DESCRIPTION	QTY
	87093	24" Hydraulic Fan Assy	
	307397	24" Hydraulic Fan Assy	
	87105	Disc - Assy RH, Includes 32,34-37,39,40	
	87106	Disc - Assy LH, Includes 33,34-36,38-40	
	87105-X2	Disc - Assy RH 1/4" Disc, Includes 32,34-37,39,40	
	87106-X2	Disc - Assy LH 1/4" Disc, Includes 33,34-36,38-40	
1	87069	Plate – Back 304	1
2	87082	Mount – Motor Wldmt	1
3	87021	Shaft – Support Wldmt	1
4	87023	Plate – Shaft Mount	1
5	87032-X1	Guard – Spinner Wldmt	1
6	307477	Handle - 304	1
7	87170	Jack – Coated Assy	1
8	87053	Angle – Valve Mount	1
9	43510	Valve – Flow Divider	1
10	305944	Motor – Spinner Style II	2



<u>ITEM</u>	<u>PART NO.</u>	<u>DESCRIPTION</u>	<u>QTY</u>
11	36402	Cap Screw - 1/2 x 1-1/4	12
12	36426	Washer – Flat 1/2	4
13	36422	Washer – Lock 1/2	10
14	39016	Nut – Lock 1/2	5
15	36401	Cap Screw - 1/2 x 1	2
16	36398	Cap Screw - 3/8 x 1	4
17	36425	Washer – Flat 3/8	4
18	36420	Washer – Lock 3/8	4
19	36414	Nut – Hex 3/8	5
20	6072	Zerk – Grease	2
21	6547	Pin – Clevis	1
22	80798	Cap Screw – 1/2 x 3-3/4	1
23	36429	Pin – Hair	1
24	85002	U-Joint	1
25	34865	Cap Screw – 1/4 x 2 1/4	1
26	36395	Cap Screw – 1/4 x 1	1
27	36423	Washer – Flat 1/4	1
28	36418	Washer – Lock 1/4	2
29	36412	Nut – Hex 1/4	2
30	20918	Pin – Roll	2
31	305571	Washer – Rubber	2
32	27056-X4	Disc – Distributor RH	1
	57830-X2	Disc – Distributor RH 1/4"	1
33	27056-X5	Disc – Distributor LH	1
	57830-X3	Disc – Distributor LH 1/4"	1
34	10877	Hub	2
35	20004	Cap Screw - 1/4 x 7/8	12
36	20676	Nut - Lock 1/4	12
37	309091	Fin - RH Wldmt	4
38	309092	Fin – LH Wldmt	4
39	20034	Cap Screw – 5/16 x 3/4	24
40	20677	Nut – Lock 5/16	24
41	36402	Cap Screw - 1/2 x 1 1/4	12
42	*36416	Nut – Hex 1/2	4
43	*36940	Bolt – Carriage 1/2 x 2	4
44	*36426	Washer – Flat 1/2	4
45	*36422	Washer – Lock 1/2	4
46	*56397-X1	Washer	2

* - Not Shown – 42 through 45 used to attach spinner to sills; 46 between motor shaft and hub plate.

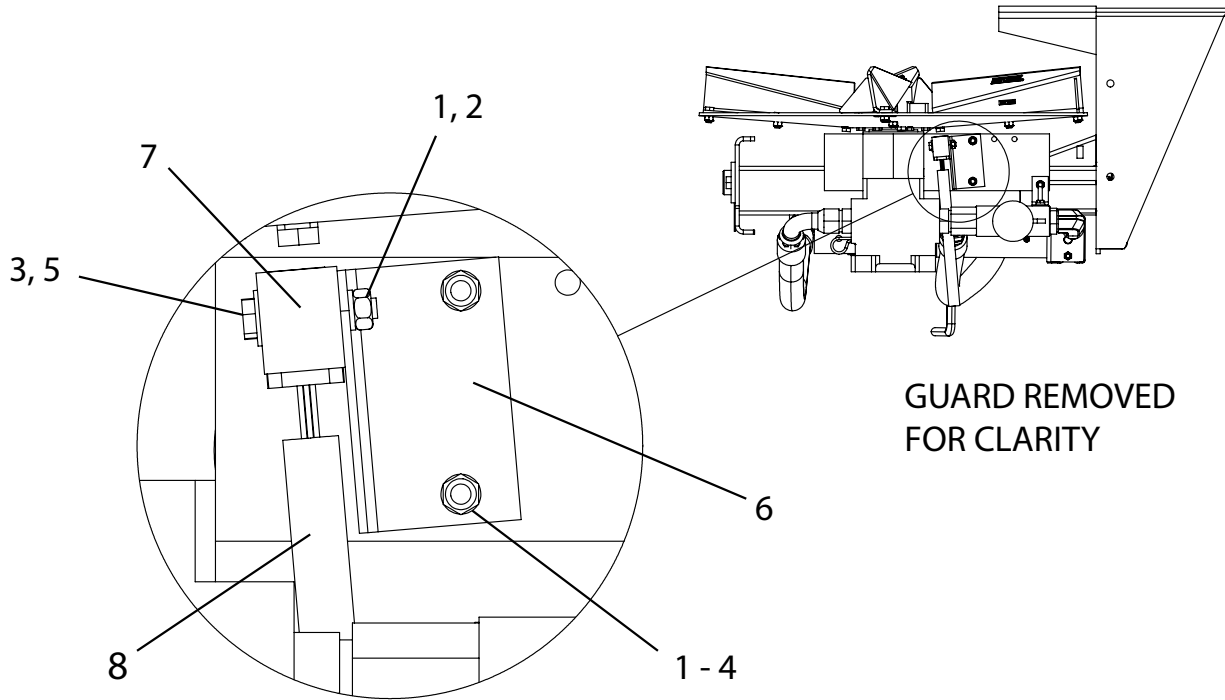

Click or Scan - Spinner Speed Sensor Test Procedure



Click or Scan - Spinner Speed Sensor Installation Procedure

<u>ITEM</u>	<u>PART NO.</u>	<u>DESCRIPTION</u>	<u>QTY</u>
	97310	Sensor – Kit Spinner (Includes Items 1 - 8)	
1	36412	Nut – Hex 1/4 SS	6
2	36418	Washer – Lock 1/4 SS	6
3	36423	Washer – Flat 1/4 SS	3
4	36393	Cap Screw – 1/4 x 3/4 SS	2
5	42448	Cap Screw – 1/4 x 1-1/2 SS	2
6	86672	Bracket	1
7	89011	Sensor – Assy	1
8	89009	Cable – Sensor Extension	1

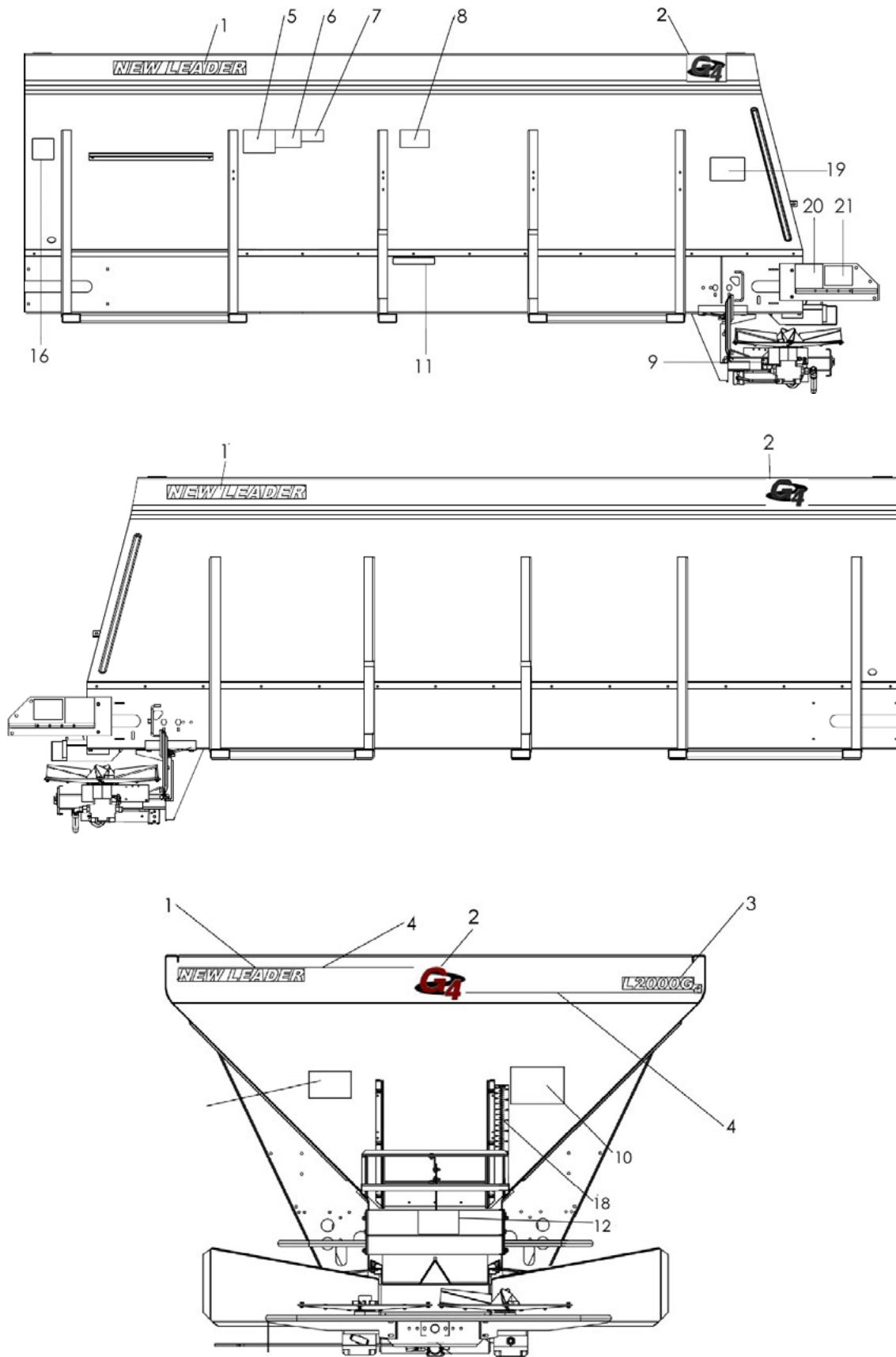

Please Give Part No., Description & Unit Serial No.



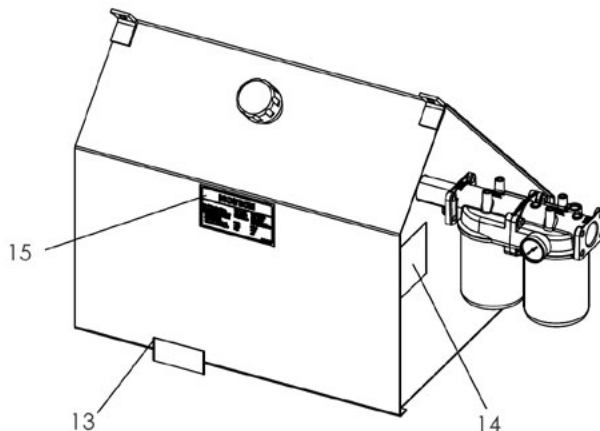

<u>ITEM</u>	<u>PART NO.</u>	<u>DESCRIPTION</u>	<u>QTY</u>
	58636	Decal - Safety, Includes 5-8,11,18,19	
1	87164	Decal - New Leader, Black	3
2	87129	Decal - G4 Black/White	3
	87122	Decal - G4 Black/Red	3
3	307457	L2000G4 Black	1
4	87162	Decal - Striping Black	ft AR
5	150034	Decal - Caution, Improper Operation	1
6	364	Decal - Warning, Stay Out of Box	2
7	321	Decal - Caution, Material to be Spread	1
8	39138	Decal - Warning, Hot Components	1
9	87110	Decal - Scale	1
10	368	Decal - Flying Material	1
11	39200	Decal - Fender Capacity	2
12	87109	Decal - New Leader G4 Series	1
13	8664	Decal - Keep Valve Open	1
14	39378	Decal - Change Filter Element	1
15	8665	Decal - Hydraulic Oil Only	1
16	21476	Decal - Notice Conveyor Chain	1
17	71526	Decal - Notice, Adjust Spinner	1
18	23769	Decal - Feedgate Slide Scale	1
19	21477	Decal - Notice Spreader Hopper	1
20	55630	Decal - Warning, No Step	2
21	55631	Decal - Warning, Guard for Protection	2